



FOX VALLEY MODELS HO SCALE PULLMAN-STANDARD DINER, NORFOLK & WESTERN/POWHATAN ARROW

The Powhatan Arrow was Norfolk & Western Railway's premier train between Norfolk, Virginia, and Cincinnati, Ohio. Introduced in 1946, it received streamlined cars in 1949 before undergoing significant alterations in 1958, including the addition of mail cars and the replacement of observation cars with diner-lounges. By 1969, declining passenger numbers led to the Powhatan Arrow's discontinuation, but its legacy

endures through preserved Class J Steam Locomotive 611 at the Virginia Museum of Transportation.

The Fox Valley Models™ HO Scale N&W Powhatan Arrow Passenger Car accurately replicates the prototype's streamlined consist from the early 1950s and pairs perfectly with our HO Scale N&W J Class 4-8-4 Steam Locomotive model.

DETAILED SCALETRAINS

- **Era: 1946 to 1969**
- **D1 class 36 seat diner**
- **Fully-assembled**
- **Accurate road numbers**
- **Detailed car bodies**
- **LED-illuminated overhead interior lighting**
- **End-of-car diaphragms**
- **Detailed car interiors**
- **Detailed underframe**
- **Factory-applied metal grab irons, coupler cut levers, and trainline hoses with connection pipe with silver gladhands**
- **Durable body-mounted die-cast metal semi-scale long-shank Type E knuckle couplers**
- **Die-cast 4-wheel trucks**
- **36" machined metal wheels with accurately profiled .110" wide wheel tread**
- **Operates on Code 70, 83, and 100 rail**
- **Printing and lettering legible even under magnification**
- **Weighted to Industry standards for reliable operation**
- **Packaging safely stores the model**
- **Minimum radius: 22"**
- **Recommended radius: 24"**

ScaleTrains • 4901 Old Tasso Rd NE, Cleveland, TN 37312 • www.ScaleTrains.com
Toll-Free 844-9TRAINS • International 423-299-3689

WARNING: This product may contain a chemical known to the State of California to cause cancer or birth defects or other reproductive harm.
© 2025 ScaleTrains.com, Inc., ScaleTrains, Fox Valley Models and respective logos and slogans are trademarks of ScaleTrains.com, Inc.



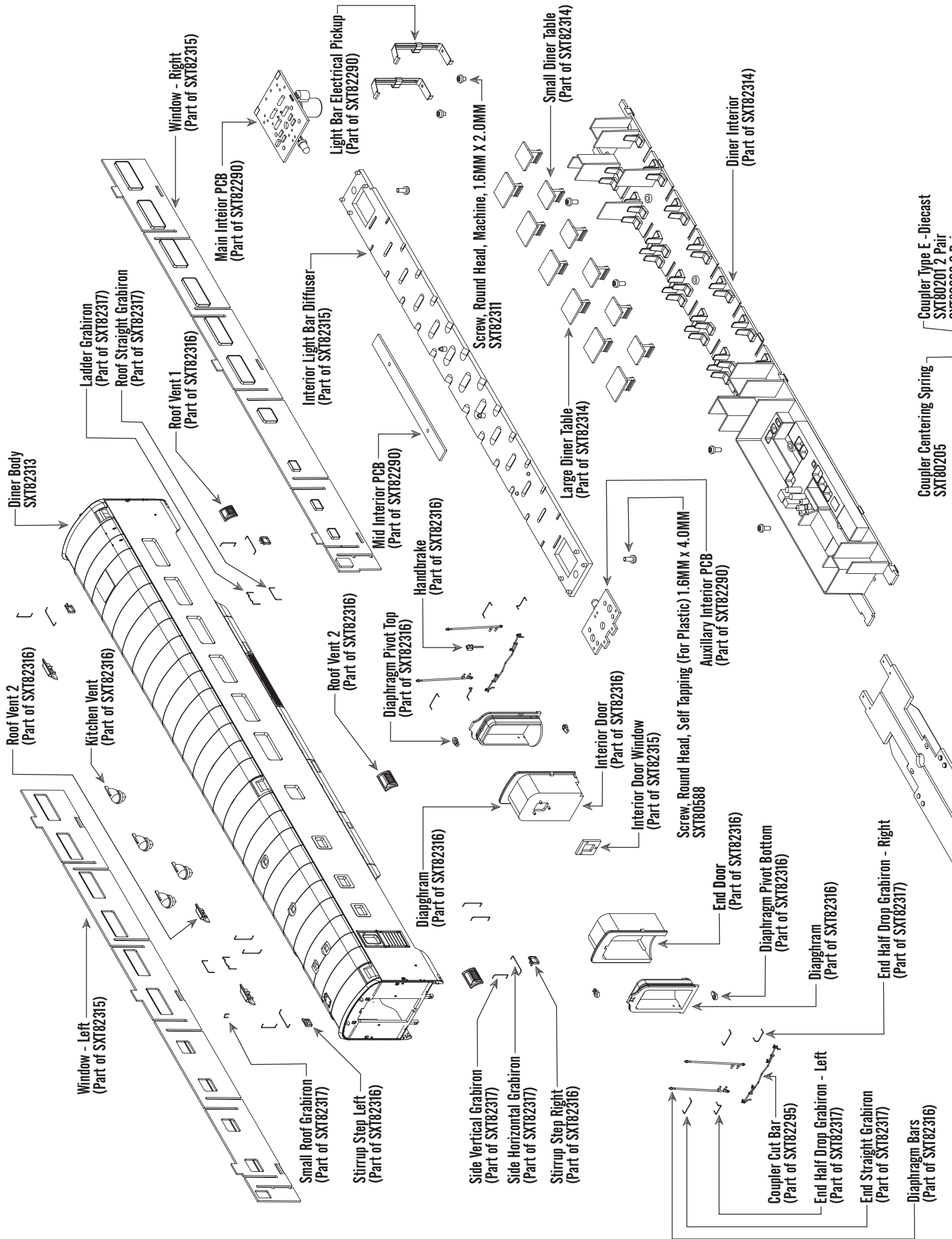

Roof Vent 2
(Part of SXT82316)

Window - Left
(Part of SXT82315)

Kitchen Vent
(Part of SXT82316)

Ladder Grabiron
(Part of SXT82317)

Roof Straight Grabiron
(Part of SXT82317)

Roof Vent 1
(Part of SXT82316)

Window - Right
(Part of SXT82315)

Main Interior PCB
(Part of SXT82290)

Small Roof Grabiron
(Part of SXT82317)

Stirrup Step Left
(Part of SXT82316)

Interior Light Bar Diffuser
(Part of SXT82315)

Light Bar Electrical Pickup
(Part of SXT82290)

Mid Interior PCB
(Part of SXT82290)

Roof Vent 2
(Part of SXT82316)

Diaphragm
(Part of SXT82316)

Handbrake
(Part of SXT82316)

Side Vertical Grabiron
(Part of SXT82317)

Side Horizontal Grabiron
(Part of SXT82317)

Stirrup Step Right
(Part of SXT82316)

Diaphragm Pivot Top
(Part of SXT82316)

Interior Door
(Part of SXT82316)

Interior Door Window
(Part of SXT82315)

End Door
(Part of SXT82316)

Coupler Cut Bar
(Part of SXT82295)

End Half Drop Grabiron - Left
(Part of SXT82317)

End Straight Grabiron
(Part of SXT82317)

Small Diner Table
(Part of SXT82314)

Large Diner Table
(Part of SXT82314)

Auxiliary Interior PCB
(Part of SXT82290)

Screw, Round Head, Self Tapping (For Plastic) 1.6MM x 4.0MM
SXT80588

Diaphragm Pivot Bottom
(Part of SXT82316)

Diaphragm
(Part of SXT82316)

End Half Drop Grabiron - Right
(Part of SXT82317)

Diaphragm Bars
(Part of SXT82316)

Interior Door
(Part of SXT82316)

Screw, Round Head, Machine, 1.6MM x 2.0MM
SXT82311

End Door
(Part of SXT82316)

Coupler Type E - Diecast
SXT80201 2 Pair
SXT80202 6 Pair

Coupler Centering Spring
SXT80205

Diner Interior
(Part of SXT82314)

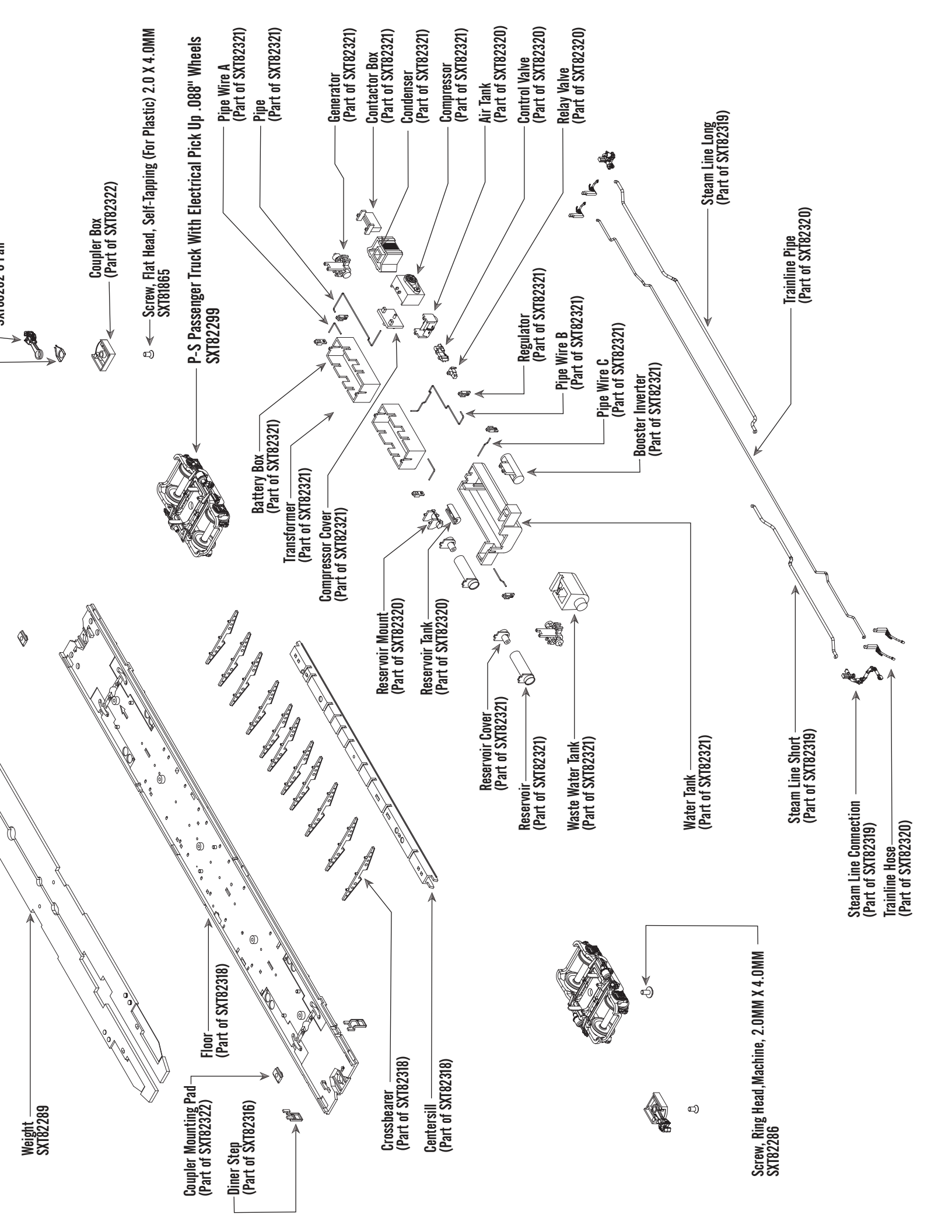

FOX VALLEY MODELS HO SCALE PULLMAN-STANDARD DINER, NORFOLK & WESTERN/POWHATAN ARROW

SXT82312	Instructions Fox Valley Models HO Scale Pullman-Standard Diner, Norfolk & Western/Powhatan Arrow	SXT82317	Wire Grabiron Set	SXT80202	Type E Coupler, Die Cast -6 pr
SXT82313	Body	SXT82295	Coupler Cut Bar Set	SXT82321	Underbody Detail Set
SXT82289	Weight	SXT82318	Floor and Underframe Assembly	SXT82322	Coupler Box Assembly
SXT82290	Interior Light Set	SXT82319	Steam Line Assembly	SXT81865	Screw, Flat Head, Self-Tapping (For Plastic) 2.0 X 4.0MM
SXT82314	Interior Set	SXT82320	Brake Detail Set	SXT80588	Screw, Round Head, Self Tapping (For Plastic) 1.6MM x 4.0MM
SXT82315	Window and Clear Parts Set	SXT82299	Assembled Truck	SXT82286	Screw, Ring Head, Machine, 2.0MM X 4.0MM
SXT82316	Body Detail Set	SXT80205	Coupler Centering Spring	SXT82311	Screw, Round Head, Machine, 1.6MM X 2.0MM
		SXT80206	Coupler Knuckle Spring		
		SXT80201	Type E Coupler, Die Cast -2 pr		

For a list of parts included in each parts set, see the exploded view.



PRODUCT SUPPORT

U.S. 844-9TRAINS; 844-987-2467 Ext. 2
International 423-299-3689
Support@ScaleTrains.com



www.ScaleTrains.com

SIGNUP FOR OUR WEEKLY NEWSLETTER

www.ScaleTrains.com/newsletter



ScaleTrains

4901 Old Tasso Rd NE,
Cleveland, TN 37312 USA



FOLLOW SCALETRAINS



WARRANTY POLICY

ScaleTrains.com, Inc. (ScaleTrains) warrants products purchased from our website to be free from defects in material and workmanship for a period of two (2) years from the date of purchase. Products purchased directly from ScaleTrains are automatically registered and a receipt is not required for proof of purchase.

ScaleTrains warrants products purchased from an authorized Select Retailer to be free from defects in material and workmanship for a period of one (1) year from the date of purchase. The warranty period can be extended to two (2) years by registering the product within 30 days of purchase on our website at www.ScaleTrains.com/warranty. Be sure to retain the receipt as proof of purchase as it may be required in the event your model requires warranty service by our Service Center.

If the product fails during the limited warranty period, carefully pack the model in the original packaging. Be sure to include an explanation of the issue(s) along with your name, address, phone and email. If the product(s) were purchased from a Select Retailer, include a legible copy of the sales receipt.

Ship item(s) for repair to our Service Center at...

ScaleTrains Service Center
4901 Old Tasso Road NE
Cleveland, TN 37312

We recommend using a trackable shipping service. Shipping damage incurred on the way to our service center and costs associated with shipping are not covered under warranty.

Damages due to improperly storing, handling, or packaging are not covered under warranty.

If ScaleTrains.com deems the product to be defective, we will either (1) repair (2) replace the item, or (3) offer a store credit redeemable at ScaleTrains.com toward a future purchase. This determination is at the sole discretion of ScaleTrains.

ScaleTrains has the final decision on all warranty matters. The warranty policy is subject to change without notice.