



## FOX VALLEY MODELS HO SCALE PULLMAN-STANDARD COMPARTMENT COACH, NORFOLK & WESTERN/POWHATAN

The Powhatan Arrow was Norfolk & Western Railway's premier train between Norfolk, Virginia, and Cincinnati, Ohio. Introduced in 1946, it received streamlined cars in 1949 before undergoing significant alterations in 1958, including the addition of mail cars and the replacement of observation cars with diner-lounges. By 1969, declining passenger numbers led to the Powhatan Arrow's discontinuation, but its legacy

endures through preserved Class J Steam Locomotive 611 at the Virginia Museum of Transportation.

**The Fox Valley Models™** HO Scale N&W Powhatan Arrow Passenger Car accurately replicates the prototype's streamlined consist from the early 1950s and pairs perfectly with our HO Scale N&W J Class 4-8-4 Steam Locomotive model.

## DETAILED SCALETRAINS

- **Era: 1946 to 1969**
- **P2 class 66 seat compartment (divided) coach**
- **Fully-assembled**
- **Accurate road numbers**
- **Detailed car bodies**
- **LED-illuminated overhead interior lighting**
- **End-of-car diaphragms**
- **Detailed car interiors**
- **Detailed underframe**
- **Factory-applied metal grab irons, coupler cut levers, and trainline hoses with connection pipe with silver gladhands**
- **Durable body-mounted die-cast metal semi-scale long-shank Type E knuckle couplers**
- **Die-cast 4-wheel trucks**
- **36" machined metal wheels with accurately profiled .110" wide wheel tread**
- **Operates on Code 70, 83, and 100 rail**
- **Printing and lettering legible even under magnification**
- **Weighted to Industry standards for reliable operation**
- **Packaging safely stores the model**
- **Minimum radius: 22"**
- **Recommended radius: 24"**

ScaleTrains • 4901 Old Tasso Rd NE, Cleveland, TN 37312 • [www.ScaleTrains.com](http://www.ScaleTrains.com)  
Toll-Free 844-9TRAINS • International 423-299-3689

WARNING: This product may contain a chemical known to the State of California to cause cancer or birth defects or other reproductive harm.  
© 2025 ScaleTrains.com, Inc., ScaleTrains, Fox Valley Models and respective logos and slogans are trademarks of ScaleTrains.com, Inc.



SXT82302

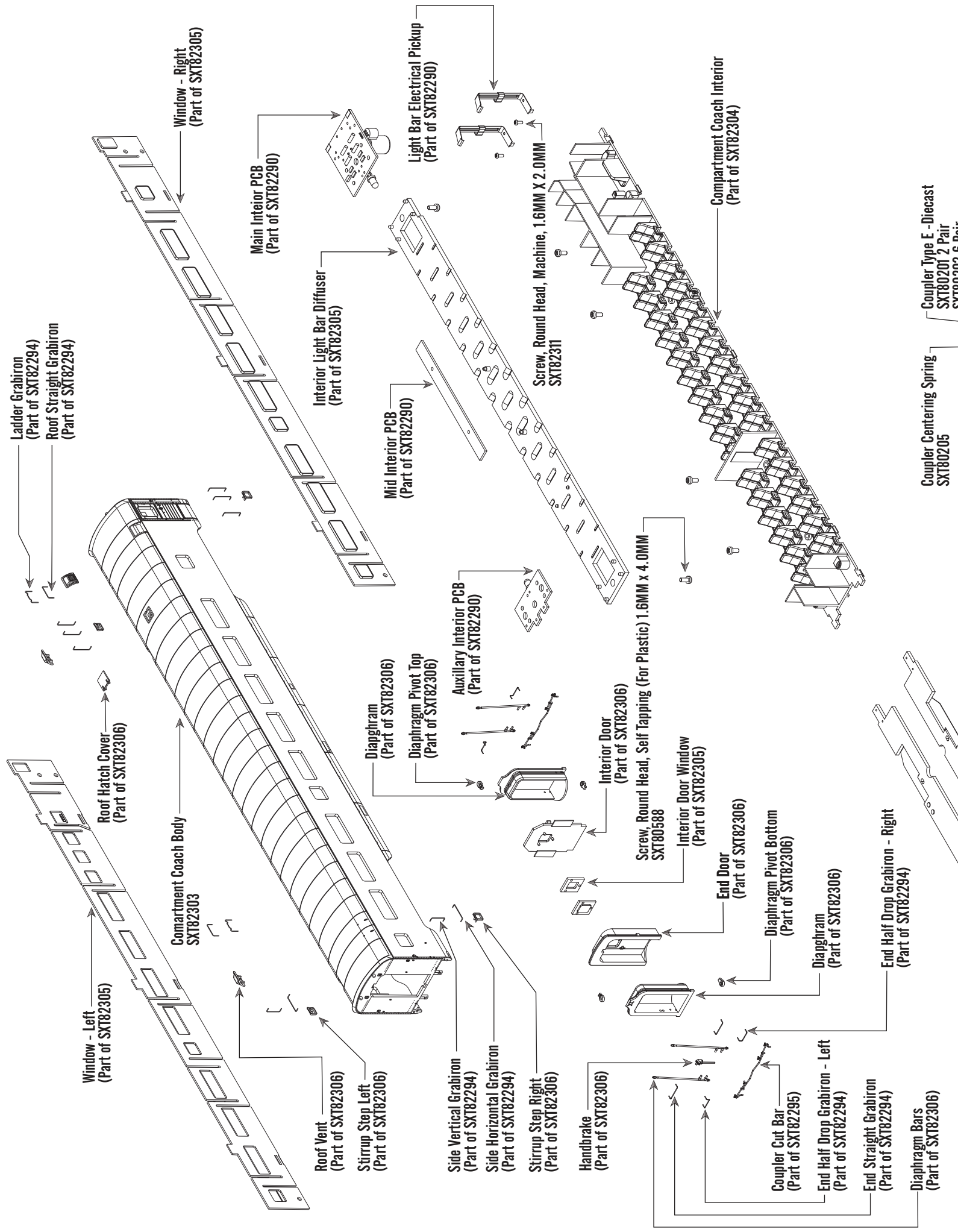

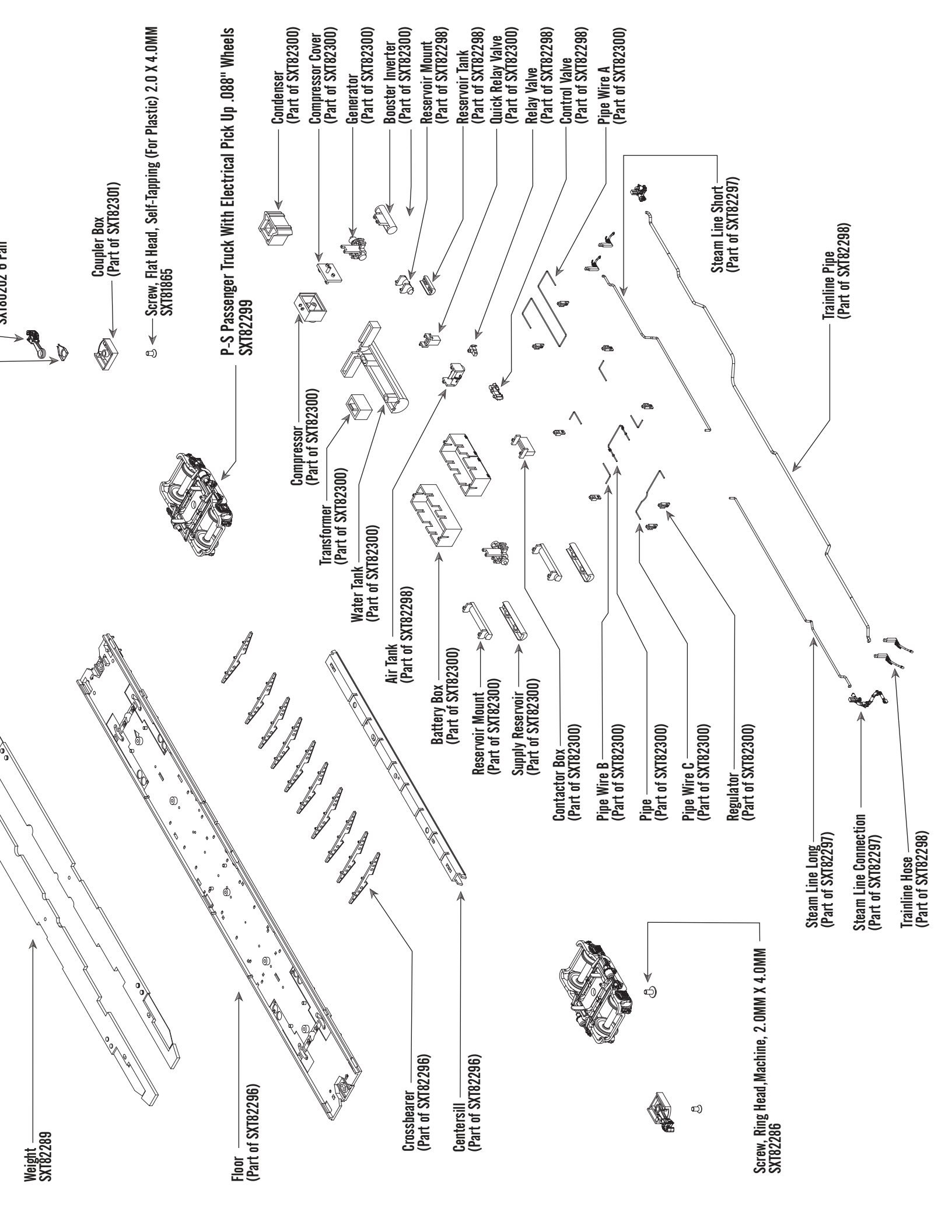

# FOX VALLEY MODELS HO SCALE PULLMAN-STANDARD COMPARTMENT COACH, NORFOLK & WESTERN/POWHATAN ARROW

SXT82302 Instructions Fox Valley Models HO  
Scale Pullman-Standard  
Compartment Coach, Norfolk &  
Western/Powhatan Arrow

SXT82303 Body

SXT82289 Weight

SXT82290 Interior Light Set

SXT82304 Interior Set

SXT82305 Window and Clear Parts Set

SXT82306 Body Detail Set

SXT82294 Wire Grabiron Set

SXT82295 Coupler Cut Bar Set

SXT82296 Floor and Underframe Assembly

SXT82297 Steam Line Assembly

SXT82298 Brake Detail Set

SXT82299 Assembled Truck

SXT80205 Coupler Centering Spring

SXT80206 Coupler Knuckle Spring

SXT80201 Type E Coupler, Die Cast -2 pr

SXT80202 Type E Coupler, Die Cast -6 pr

SXT82300 Underbody Detail Set

SXT82301 Coupler Box Assembly

SXT81865 Screw, Flat Head, Self-Tapping (For Plastic)  
2.0 X 4.0MM

SXT80588 Screw, Round Head, Self Tapping (For Plastic)  
1.6MM x 4.0MM

SXT82286 Screw, Ring Head, Machine, 2.0MM X 4.0MM

SXT82311 Screw, Round Head, Machine, 1.6MM X 2.0MM

For a list of parts included in each parts set, see the exploded view.



## PRODUCT SUPPORT

U.S. 844-9TRAINS; 844-987-2467 Ext. 2  
International 423-299-3689  
Support@ScaleTrains.com



[www.ScaleTrains.com](http://www.ScaleTrains.com)

**SIGNUP FOR OUR WEEKLY NEWSLETTER**

[www.ScaleTrains.com/newsletter](http://www.ScaleTrains.com/newsletter)



## ScaleTrains

4901 Old Tasso Rd NE,  
Cleveland, TN 37312 USA



FOLLOW SCALETRAINS



## WARRANTY POLICY

ScaleTrains.com, Inc. (ScaleTrains) warrants products purchased from our website to be free from defects in material and workmanship for a period of two (2) years from the date of purchase. Products purchased directly from ScaleTrains are automatically registered and a receipt is not required for proof of purchase.

ScaleTrains warrants products purchased from an authorized Select Retailer to be free from defects in material and workmanship for a period of one (1) year from the date of purchase. The warranty period can be extended to two (2) years by registering the product within 30 days of purchase on our website at [www.ScaleTrains.com/warranty](http://www.ScaleTrains.com/warranty). Be sure to retain the receipt as proof of purchase as it may be required in the event your model requires warranty service by our Service Center.

If the product fails during the limited warranty period, carefully pack the model in the original packaging. Be sure to include an explanation of the issue(s) along with your name, address, phone and email. If the product(s) were purchased from a Select Retailer, include a legible copy of the sales receipt.

Ship item(s) for repair to our Service Center at...

**ScaleTrains Service Center**  
4901 Old Tasso Road NE  
Cleveland, TN 37312

We recommend using a trackable shipping service. Shipping damage incurred on the way to our service center and costs associated with shipping are not covered under warranty.

Damages due to improperly storing, handling, or packaging are not covered under warranty.

If ScaleTrains.com deems the product to be defective, we will either (1) repair (2) replace the item, or (3) offer a store credit redeemable at ScaleTrains.com toward a future purchase. This determination is at the sole discretion of ScaleTrains.

ScaleTrains has the final decision on all warranty matters. The warranty policy is subject to change without notice.