



OPERATOR™ HO SCALE TRINITY 60' 7500 SERIES HIGH-CUBE BOXCAR

Since the late 1990s, Trinity has built over 10,000 60' Plate F boxcars. Within these many cars are dozens of variations of door sizes, roofs, underframes, and side post arrangements. Today, everything from lumber, steel, beer, and appliances can be seen filling the walls of this staple of modern railroading seen on almost every manifest freight on the rails.

Our value-priced **Operator™** model of the Trinity 7500 Hi-Cube Boxcar features a common body style with four 3-rib panels over the car ends and six 2-rib panels over 8' double plug doors with an upstanding flange seam roof. The rooftop panel pattern is 4 (3 rib panels), 6 (2 rib panels), and 4 (3 rib panels). The car also features ASF Motion Control Trucks with finely rendered raised foundry data.

ROADNAME AND ROAD NUMBER SPECIFIC SCALETRAINS

- **All-new model**
- **Era: 2022 to present**
- **Series 700000 to 700499 built 05/2022**
- **Road numbers 700012, 700035, 700049, 700060, 700083, and 700091**
- **Fully-assembled**
- **Multiple road numbers**
- **Double 8' plug door**
- **4 over 3 rail non-terminating ends**
- **4 3-rib panels over ends and 6 2-rib panels over doors with upstanding flange seam roof**
- **Semi-scale coupler boxes**
- **Semi-scale Type E knuckle couplers**
- **ASF Motion Control Trucks with finely rendered raised foundry data**
- **36" machined metal wheels**
- **Accurately profiled .110" wide wheel tread**
- **Operates on Code 70, 83, and 100 rail**
- **Printing and lettering legible even under magnification**
- **Weighted to Industry standards for reliable operation**
- **Packaging safely stores the model**
- **Minimum radius: 22"**
- **Recommended radius: 24"**

ScaleTrains • 4901 Old Tasso Rd NE, Cleveland, TN 37312 • www.ScaleTrains.com
Toll-Free 844-9TRAINS • International 423-299-3689

WARNING: This product may contain a chemical known to the State of California to cause cancer or birth defects or other reproductive harm.
© 2025 ScaleTrains.com, Inc., ScaleTrains, Operator and respective logos and slogans are trademarks of ScaleTrains.com, Inc.



SXT82247

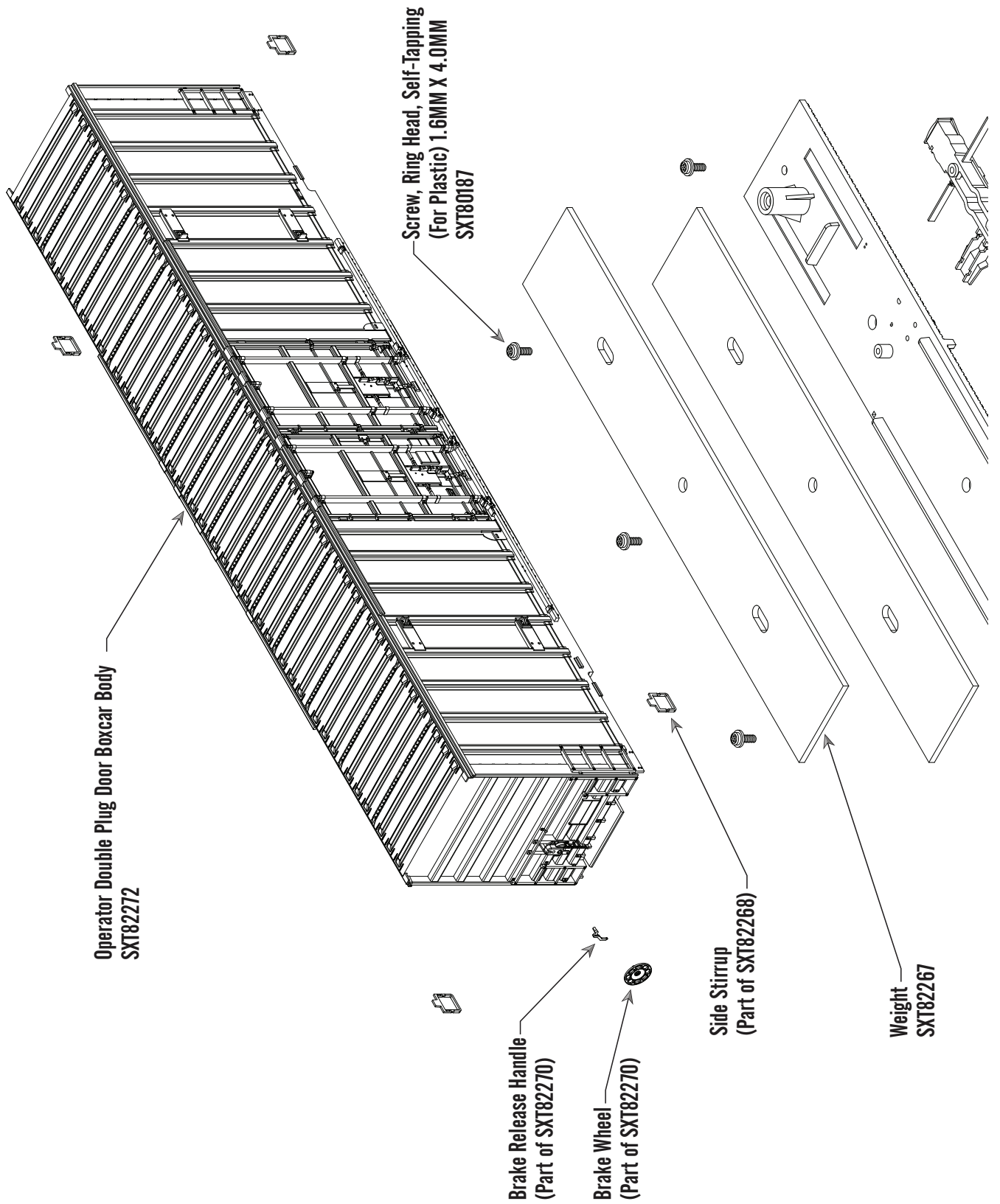

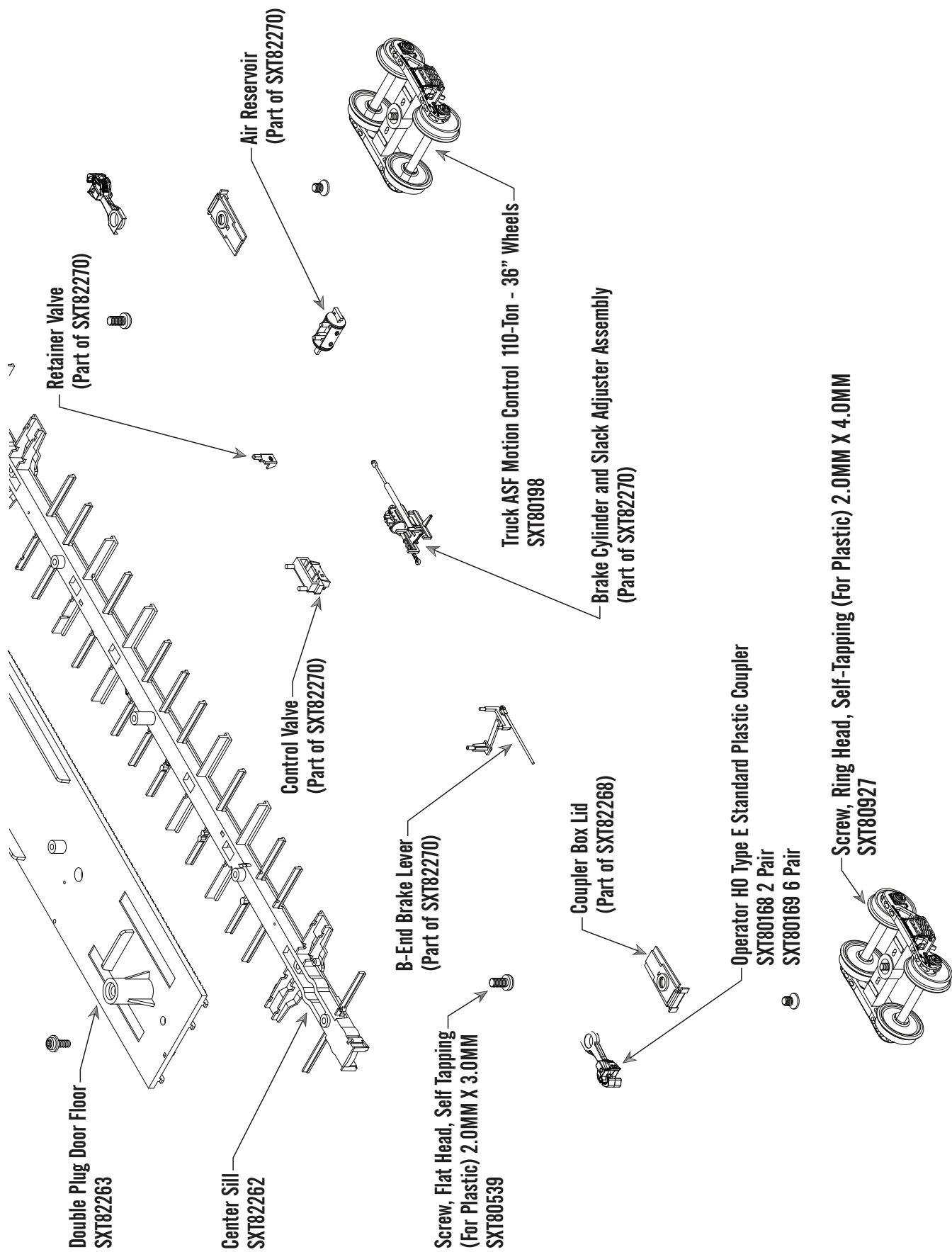

OPERATOR™ HO SCALE TRINITY 60' 7500 SERIES HIGH-CUBE BOXCAR

SXT82272 Operator Double Plug Door Boxcar Body
SXT82262 Center Sill
SXT82263 Double Plug Door Boxcar Floor
SXT82267 Weight
SXT82268 Main Double Plug Door Detail Set
SXT82270 Main Brake Detail Set
SXT80198 Truck ASF Motion Control, 110-Ton Operator 36"
Wheels .110" Tread Body Mounted Brakes

SXT80539 Screw, Flat Head, Self Tapping (For Plastic) 2.0MM X 3.0MM
SXT80927 Screw, Round Head, Self Tapping (For Plastic), 2.0MM X 4.0MM
SXT80187 Screw, Ring Head, Self-Tapping (For Plastic) 1.6MM X 4.0MM
SXT80205 Coupler Centering Spring
SXT80206 Coupler Knuckle Spring
SXT80168 Operator HO Type E Standard Plastic Coupler (2 pair)
SXT80169 Operator HO Type E coupler - Plastic 6 Pr.

For a list of parts included in each parts set, see the exploded view.



PRODUCT SUPPORT

U.S. 844-9TRAINS; 844-987-2467 Ext. 2
International 423-299-3689
Support@ScaleTrains.com



www.ScaleTrains.com

SIGNUP FOR OUR WEEKLY NEWSLETTER

www.ScaleTrains.com/newsletter



ScaleTrains

4901 Old Tasso Rd NE,
Cleveland, TN 37312 USA



FOLLOW SCALETRAINS



WARRANTY POLICY

ScaleTrains.com, Inc. (ScaleTrains) warrants products purchased from our website to be free from defects in material and workmanship for a period of two (2) years from the date of purchase. Products purchased directly from ScaleTrains are automatically registered and a receipt is not required for proof of purchase.

ScaleTrains warrants products purchased from an authorized Select Retailer to be free from defects in material and workmanship for a period of one (1) year from the date of purchase. The warranty period can be extended to two (2) years by registering the product within 30 days of purchase on our website at www.ScaleTrains.com/warranty. Be sure to retain the receipt as proof of purchase as it may be required in the event your model requires warranty service by our Service Center.

If the product fails during the limited warranty period, carefully pack the model in the original packaging. Be sure to include an explanation of the issue(s) along with your name, address, phone and email. If the product(s) were purchased from a Select Retailer, include a legible copy of the sales receipt.

Ship item(s) for repair to our Service Center at...

ScaleTrains Service Center

4901 Old Tasso Road NE
Cleveland, TN 37312

We recommend using a trackable shipping service. Shipping damage incurred on the way to our service center and costs associated with shipping are not covered under warranty.

Damages due to improperly storing, handling, or packaging are not covered under warranty.

If ScaleTrains.com deems the product to be defective, we will either (1) repair (2) replace the item, or (3) offer a store credit redeemable at ScaleTrains.com toward a future purchase. This determination is at the sole discretion of ScaleTrains.

ScaleTrains has the final decision on all warranty matters. The warranty policy is subject to change without notice.