



PRODUCT MANUAL



## RIVET COUNTER HO SCALE TRINITY 82' 7883 REEFER

In 2001, BNSF Railway turned to Trinity Railcar for a modern reefer car. Trinity built 810 reefers in the first group and another in 2003 with both groups measuring 82' long and 17' tall. Another 250 were built for JR Simplot with JRSX reporting marks. These modern reefers handle commodities like meat, vegetables, fruits, and frozen food. In addition to these specific usages, these unique reefers can be found in almost any BNSF manifest train as well as on any of the major railroads in the United States.

The new **ScaleTrains™** HO Scale **Rivet Counter™** HO Scale Trinity 82' Reefer Car model captures the **railroad, road number, and era-specific™** features of the prototype - such as smooth or ribbed rooflines, refrigeration unit and fuel tank variations, two side door types, intricate underbody detail, and much more. We're also offering sound-equipped versions with a track powered, rechargeable battery included. Sound versions feature an operating LED-lighted control panel for the first time in HO Scale.

### PROTOTYPE SPECIFIC SCALETRAINS

- Fully-assembled
- Multiple road numbers
- Sound equipped versions feature:
  - Track powered, capacitor circuit
  - Operating Led-lighted control panel
  - Sound turns on and off via a touch sensor located under the center of the car roof
  - Adjust the volume by pressing a button on the bottom of the car
- 82' 7883 cubic foot smooth side body
- 12' plug door with recessed tops section and separate door rods and door handle
- Cylindrical Refrigeration unit fuel tank
- Intricate A end refrigeration unit access platform with photo-etched metal platform deck
- Fuel tank end cage with separate plastic frame and wire grabirons
- Smooth roof
- Underbody brake rigging and components located specifically to match the 7883 cubic foot car
- Factory-applied ladders, metal grab irons, tack boards, coupler cut levers, and trainline hoses with silver gladhands
- Brake wheel, stand, and chain
- Brake plumbing with separate air reservoir, control valve, and retainer valve plus separately applied wireform plumbing including trainline pipe with brackets
- Photo-etched stainless-steel see-through Morton (stamped round hole) coupler crossover platform on B end of car
- Semi-scale coupler boxes
- Durable body-mounted die-cast metal semi-scale lower shelf Type E couplers
- Highly-detailed ASF Family of Trucks (FOT) 100-ton trucks with finely rendered raised foundry data; rotating black Timken three-sided bearing caps; separate "truck-mounted brake" brake beams; and side bearing detail
- Printed reporting mark and road number on all four trucks
- 36" machined metal wheels with accurately profiled .110" wide wheel tread
- Operates on Code 70, 83 and 100 rail
- Printing and lettering legible even under magnification
- FRA-224 yellow conspicuity stripes
- Weighted to Industry standards for reliable operation
- Packaging safely stores model
- Minimum radius: 22"
- Recommended radius: 24"

ScaleTrains • 4901 Old Tasso Rd NE, Cleveland, TN 37312 • [www.ScaleTrains.com](http://www.ScaleTrains.com)  
Toll-Free 844-9TRAINS • International 423-299-3689

WARNING: This product may contain a chemical known to the State of California to cause cancer or birth defects or other reproductive harm.  
© 2024 ScaleTrains.com, Inc., ScaleTrains, Rivet Counter and respective logos and slogans are trademarks of ScaleTrains.com, Inc.

AGES  
**14+**

SXT82036

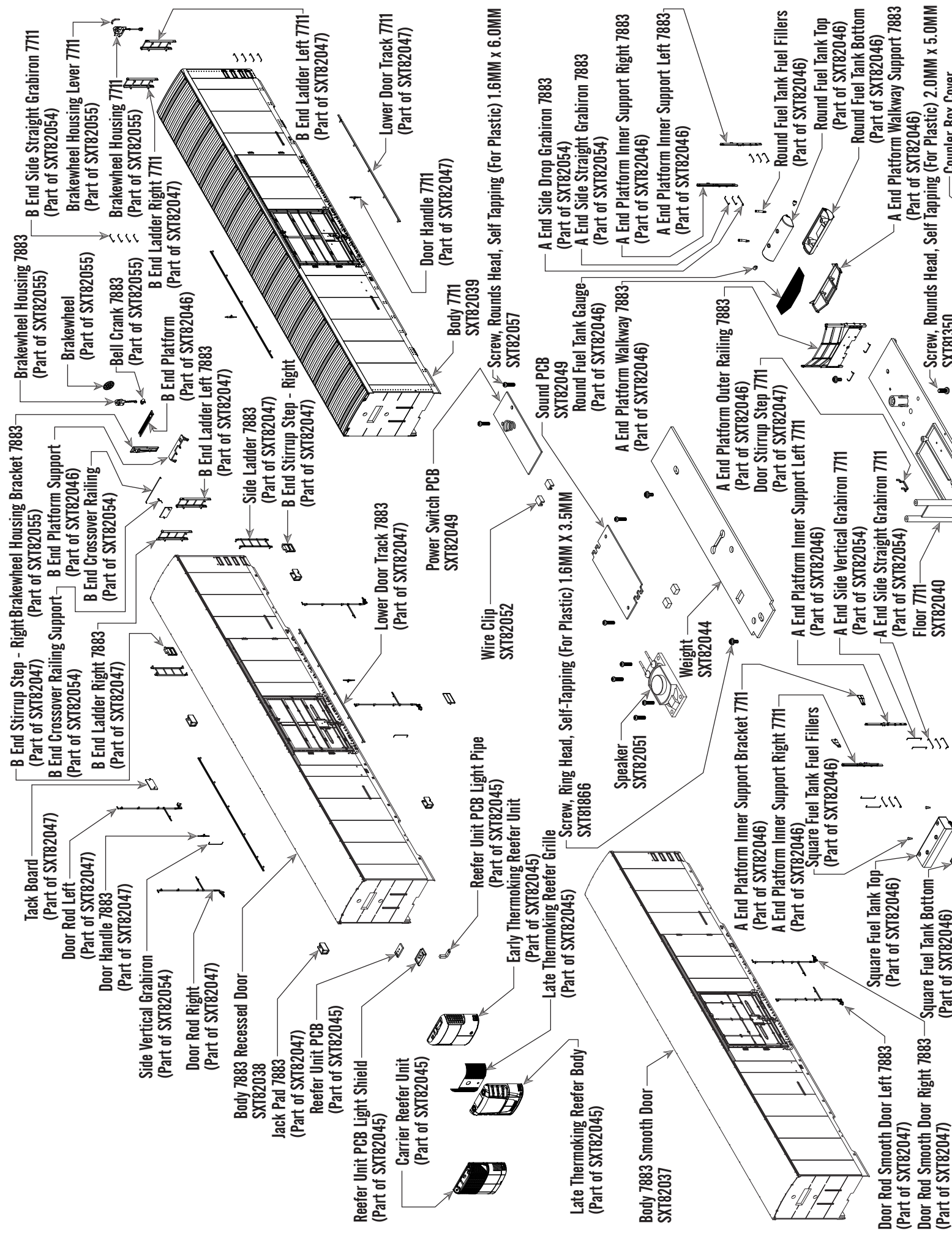

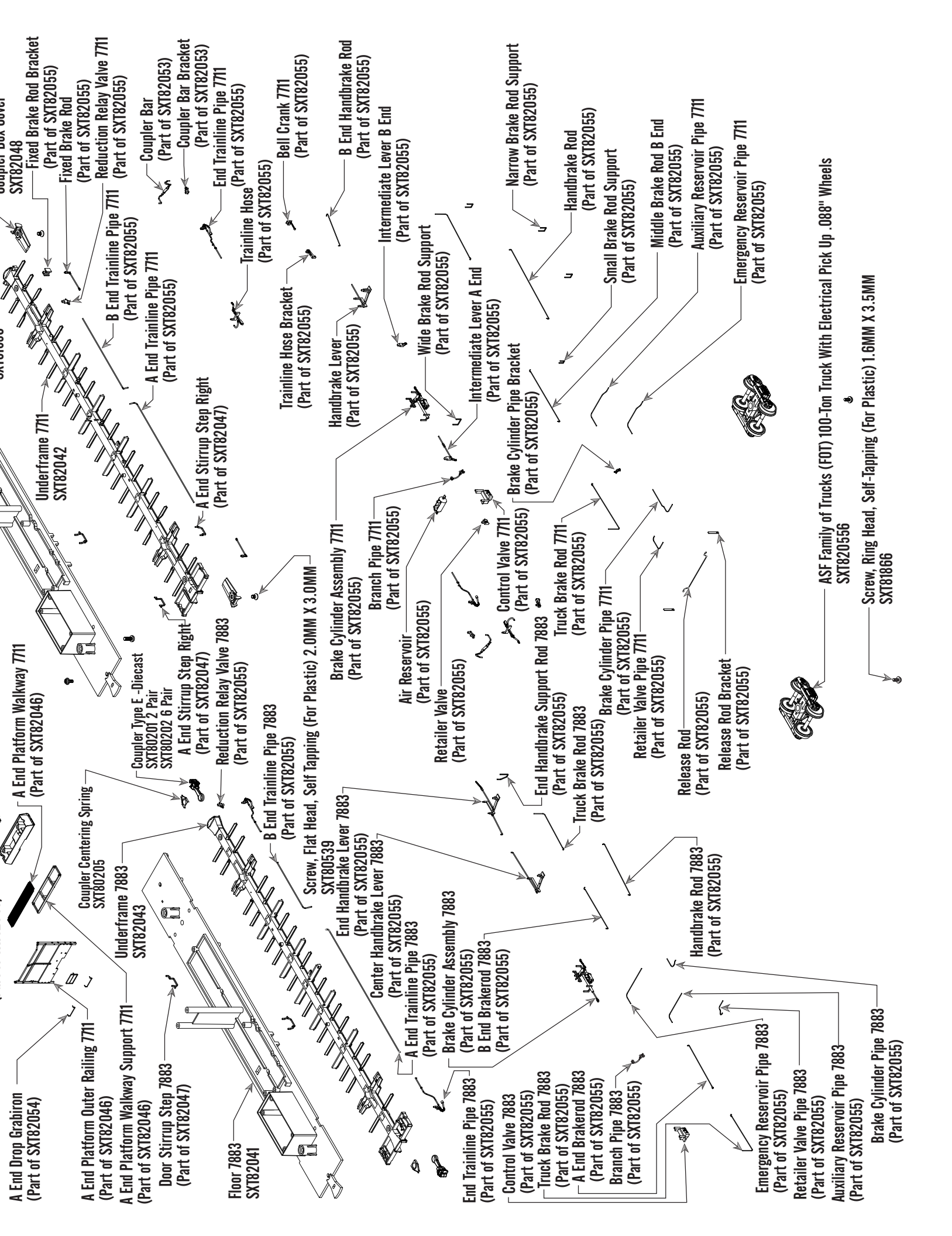

# RIVET COUNTER HO SCALE TRINITY 82' 7883 REEFER

SXT82036	Instructions for HO RC Trinity 82' Reefer	SXT82045	Reefer Unit Set	SXT82054	Grabiron and Railing Set
SXT82037	Body 7882 Smooth Top Door	SXT82046	End Platform Set (Plastic and Etched Parts)	SXT82055	Brake Detail Set
SXT82038	Body 7882 Recessed Door	SXT82047	Body Detail Set (Plastic Parts)	SXT82056	ASF Family of Trucks (FOT) 100-Ton Truck With Electrical Pick Up .088" Wheels
SXT82039	Body 7711	SXT82048	Coupler Box Cover	SXT81866	Screw, Ring Head, Self-Tapping (For Plastic) 1.6MM X 3.5MM
SXT82040	Floor 7711	SXT82049	Power Switch PCB	SXT82057	Screw, Rounds Head, Self Tapping (For Plastic) 1.6MM x 6.0MM
SXT82041	Floor 7883	SX82050	Sound PCB	SXT81350	Screw, Rounds Head, Self Tapping (For Plastic) 2.0MM x 5.0MM
SXT82042	Underframe 7711	SXT82051	Speaker	SXT80539	Screw, Flat Head, Self Tapping (For Plastic) 2.0MM X 3.0MM
SXT82043	Underframe 7883	SXT82052	Wire Clip		
SXT82044	Weight	SXT82053	Coupler Bar and Bracket		

For a list of parts included in each parts set, see the exploded view.

## Function of Sound System in Trinity 82' Reefer

The HO Rivet Counter 82' Trinity Reefer sound runs on a track-powered system that uses capacitors to allow the sound to run for a short time to compensate for intermittent electrical pick-up. The system uses a touch sensor that is located under the center of the roof section above the doors. To activate the system, place three fingers on the roof just above the doors. The small control panel light on the reefer unit will turn on and the sound will start. While in operation, the sound will cycle on and off randomly like the prototype. There's a small push button on the bottom of the car for volume adjustment with up to 4 levels to choose from. Each

push of the button will increase the volume level. Once the maximum level is achieved, pushing the button again will turn off the sound but not the system itself. Pressing the button once more will activate the sound again at the lowest level, restarting the cycle. Once you have selected the desired sound volume, you can place the reefer on the track and the volume level will stay at the desired setting. Once adjusted, place three fingers on the roof of the car to turn off the sound system. Verify the system is off by checking the control panel light. It will take a few seconds to discharge the capacitors and then the system will turn off.



### PRODUCT SUPPORT

U.S. 844-9TRAINS; 844-987-2467 Ext. 2  
International 423-299-3689  
[Support@ScaleTrains.com](mailto:Support@ScaleTrains.com)



### ScaleTrains

4901 Old Tasso Rd NE,  
Cleveland, TN 37312 USA



[www.ScaleTrains.com](http://www.ScaleTrains.com)

**SIGNUP FOR OUR WEEKLY NEWSLETTER**

[www.ScaleTrains.com/newsletter](http://www.ScaleTrains.com/newsletter)



FOLLOW SCALETRAINS



## WARRANTY POLICY

ScaleTrains.com, Inc. (ScaleTrains) warrants products purchased from our website to be free from defects in material and workmanship for a period of two (2) years from the date of purchase. Products purchased directly from ScaleTrains are automatically registered and a receipt is not required for proof of purchase.

ScaleTrains warrants products purchased from an authorized Select Retailer to be free from defects in material and workmanship for a period of one (1) year from the date of purchase. The warranty period can be extended to two (2) years by registering the product within 30 days of purchase on our website at [www.ScaleTrains.com/warranty](http://www.ScaleTrains.com/warranty). Be sure to retain the receipt as proof of purchase as it may be required in the event your model requires warranty service by our Service Center.

If the product fails during the limited warranty period, carefully pack the model in the original packaging. Be sure to include an explanation of the issue(s) along with your name, address, phone and email. If the product(s) were purchased from a Select Retailer, include a legible copy of the sales receipt.

Ship item(s) for repair to our Service Center at...

**ScaleTrains Service Center**

**4901 Old Tasso Road NE**

**Cleveland, TN 37312**

We recommend using a trackable shipping service. Shipping damage incurred on the way to our service center and costs associated with shipping are not covered under warranty.

Damages due to improperly storing, handling, or packaging are not covered under warranty.

If ScaleTrains.com deems the product to be defective, we will either (1) repair (2) replace the item, or (3) offer a store credit redeemable at ScaleTrains.com toward a future purchase. This determination is at the sole discretion of ScaleTrains.

ScaleTrains has the final decision on all warranty matters. The warranty policy is subject to change without notice.