



RIVET COUNTER HO SCALE BSC F68CH-DH FLATCAR

Our **Rivet Counter™** brand strives to create the most accurately detailed model trains imaginable. The real-world counterpart is meticulously researched to ensure prototype fidelity. Each model features numerous factory applied parts including **railroad, road number, and era-specific™** details whenever possible.

In 1970, BSC introduced the F68CH-DH Flatcar as a variation of the F68AH without the bulkheads. Trailer Train

used the F68CH flatcars, painted yellow with integral tie-down channels, hydraulic snubbers, and 36" wheelsets in 100-ton trucks. Trailer Train also created the F68DH variant, with tie-down tracks and a heavy-duty deck for securing loads like cable reels. Trailer Train received four groups of F68DH flats between July 1971 and October 1973 from BSC, equipped with the same features as their other F68-series flatcars.

ROADNAME AND ROAD NUMBER SPECIFIC SCALETRAINS

- **All New Model**
- **First time in HO scale**
- **Multiple road numbers**
- **Modeler-applied laser-cut wood deck**
- **Recessed deck tie-down details**
- **Two recessed tie-down channels running lengthwise down the center of the car deck(F68DC)**
- **Flush-mounted tie-down channel mounted to outer side sill on each side of car**
- **Early H-shaped jacking pads**
- **Vertical handbrake staff with brakewheel**
- **Finely detailed brake linkage, triple valve, cylinder, and actuator**
- **Factory-applied trainline pipe**
- **Durable die-cast metal semi-scale long-shank Type E couplers**
- **100-ton trucks with hydraulic snubber and bracket details, rotating bearing caps, and truck-mounted brake beams**
- **36" machined metal wheels**
- **Minimum radius: 18"**
- **Recommended radius: 22"**
- **Fully assembled**
- **Color matched to Tru-Color paint colors when possible**
- **Printing and lettering legible under magnification**
- **Accurately profiled .110" wide wheel tread**
- **Coupler cut levers**
- **Trainline hoses**
- **Intricate brake plumbing**
- **Weighted to Industry standards**
- **Operates on Code 70, 83 and 100 rail**
- **Packaging safely stores model**

ScaleTrains • 4901 Old Tasso Rd NE, Cleveland, TN 37312 • www.ScaleTrains.com
Toll-Free 844-9TRAINS • International 423-299-3689

WARNING: This product may contain a chemical known to the State of California to cause cancer or birth defects or other reproductive harm.
© 2023 ScaleTrains.com, Inc., ScaleTrains, Rivet Counter and respective logos and slogans are trademarks of ScaleTrains.com, Inc.



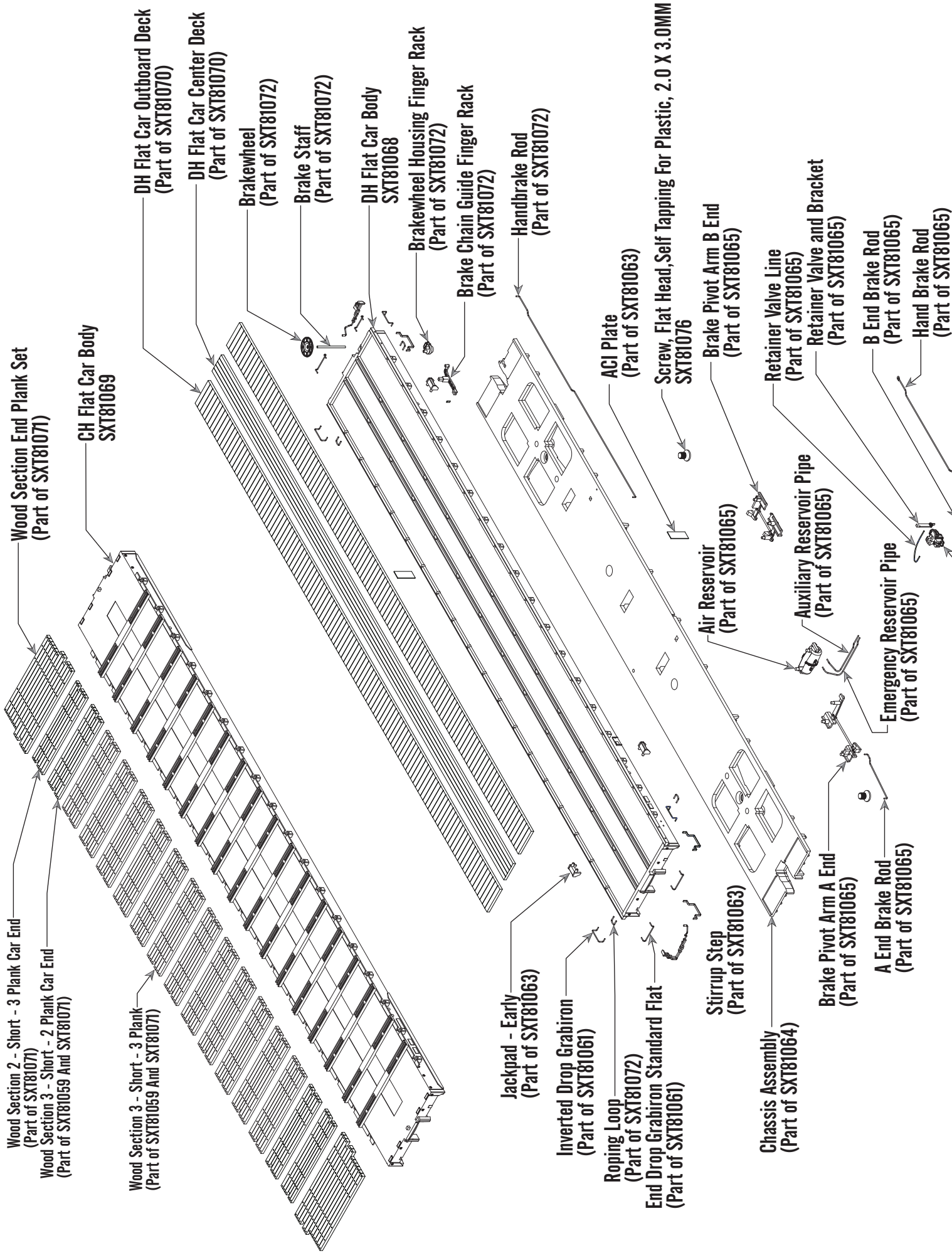

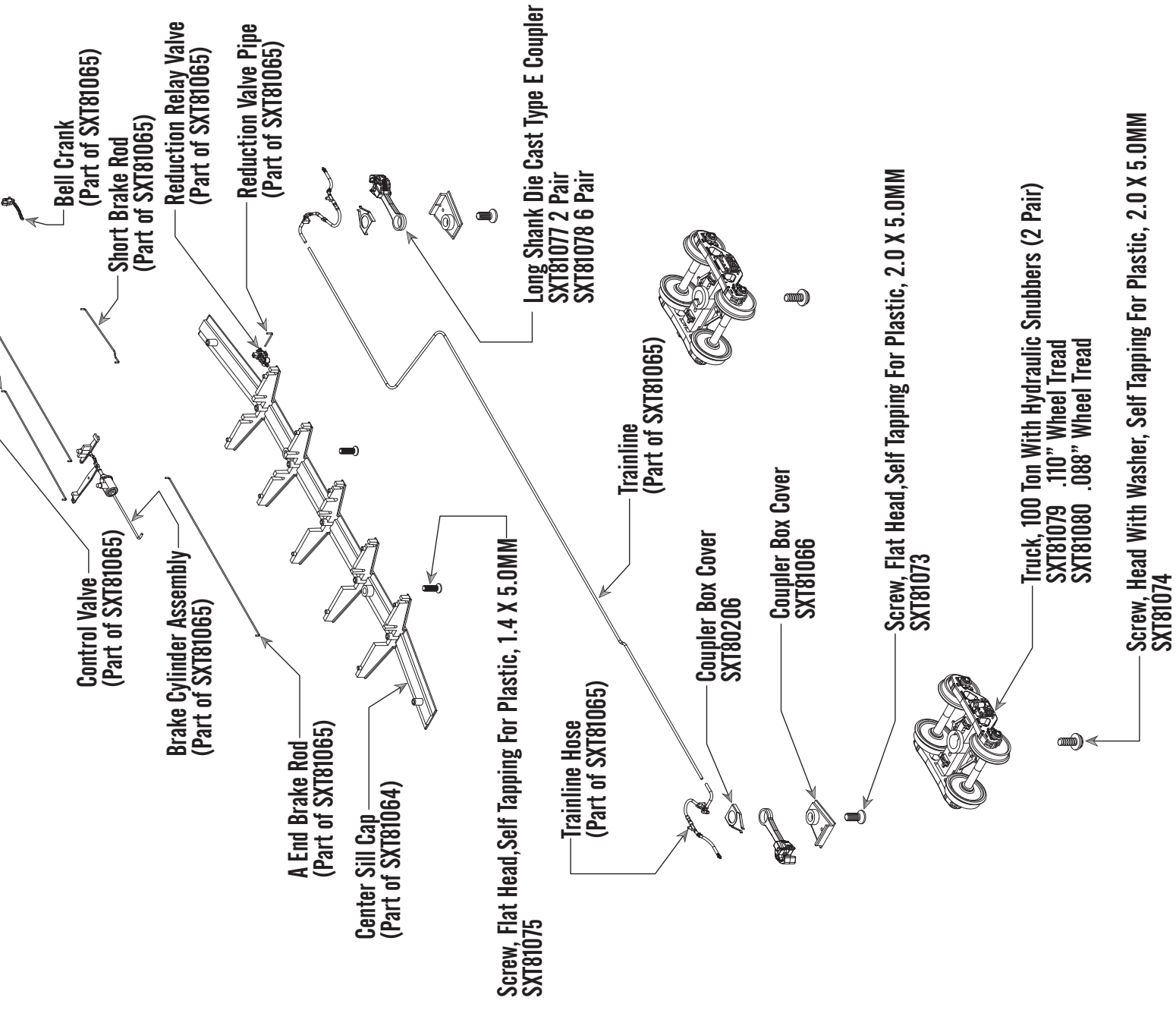

RIVET COUNTER HO SCALE BSC F68CH-DH FLATCAR PARTS LIST

SXT81627 Instruction Sheet
SXT81061 Grab Iron Set
SXT81063 Body Detail Set
SXT81064 Chassis Assembly
SXT81065 Bulkhead Brake Details Set
SXT81066 Coupler Box Cover
SXT81068 F68DH Body
SXT81069 F68CH Body

SXT81070 Flat Car Deck F68DH
SXT81071 Flat Car Deck F68CH
SXT81072 Standard Flat Car Specific Detail Set
SXT81073 Screw, Flat Head, Self Tapping For Plastic 2.0MM X 5.0MM
SXT81074 Screw, Head With Washer, Machine 2.0MM X 5.0MM
SXT81075 Screw, Flat Head, Self Tapping For Plastic 2.0MM X 3.0M
SXT81076 Screw, Flat Head, Self Tapping For Plastic 1.4MM X 5.0MM
SXT81079 100 Ton Trucks W/ Hydraulic Snubber with 36" Wheels

For a list of parts included in each parts set, see the exploded view.

ADDITIONAL PARTS AVAILABLE

SXT81077 Long Shank Type E Coupler, Diecast 2-Pair
SXT81078 Long Shank Type E Coupler, Diecast 6-Pair
SXT80205 Coupler Centering Spring
SXT80206 Coupler Knuckle Spring

SXT81080 Truck Assembly, 100 Ton With Hydraulic Snubber, .088" Tread - Rivet Counter (2 Pair)
SXT80211 Rivet Counter Wheelset 36" .088" Tread - 8 Pack
SXT80212 Rivet Counter Wheelset 36" .110" Tread - 8 Pack



PRODUCT SUPPORT

U.S. 844-9TRAINS; 844-987-2467 Ext. 2
International 423-299-3689
Support@ScaleTrains.com



ScaleTrains

4901 Old Tasso Rd NE,
Cleveland, TN 37312 USA



www.ScaleTrains.com

SIGNUP FOR OUR WEEKLY NEWSLETTER

www.ScaleTrains.com/newsletter



FOLLOW SCALETRAINS



WARRANTY POLICY

ScaleTrains.com, Inc. (ScaleTrains) warrants products purchased from our website to be free from defects in material and workmanship for a period of two (2) years from the date of purchase. Products purchased directly from ScaleTrains are automatically registered and a receipt is not required for proof of purchase.

ScaleTrains warrants products purchased from an authorized Select Retailer to be free from defects in material and workmanship for a period of one (1) year from the date of purchase. The warranty period can be extended to two (2) years by registering the product within 30 days of purchase on our website at www.ScaleTrains.com/warranty. Be sure to retain the receipt as proof of purchase as it may be required in the event your model requires warranty service by our Service Center.

If the product fails during the limited warranty period, carefully pack the model in the original packaging. Be sure to include an explanation of the issue(s) along with your name, address, phone and email. If the product(s) were purchased from a Select Retailer, include a legible copy of the sales receipt.

Ship item(s) for repair to our Service Center at...

ScaleTrains Service Center
4901 Old Tasso Road NE
Cleveland, TN 37312

We recommend using a trackable shipping service. Shipping damage incurred on the way to our service center and costs associated with shipping are not covered under warranty.

Damages due to improperly storing, handling, or packaging are not covered under warranty.

If ScaleTrains.com deems the product to be defective, we will either (1) repair (2) replace the item, or (3) offer a store credit redeemable at ScaleTrains.com toward a future purchase. This determination is at the sole discretion of ScaleTrains.

ScaleTrains has the final decision on all warranty matters. The warranty policy is subject to change without notice.