



RIVET COUNTER HO SCALE BSC F68BH FINGER RACK FLATCAR

Our Rivet Counter™ brand strives to create the most accurately detailed model trains imaginable. The real-world counterpart is meticulously researched to ensure prototype fidelity. Each model features numerous factory applied parts including **railroad, road number, and era-specific™** details whenever possible.

In 1969, Bethlehem Steel Co. (BSC) introduced a new generation of high-capacity flats called the F68-series. These flats were 100-ton and 68 feet long (over end sills). They were extremely versatile and could be equipped with various appliances from the factory to handle different loadings. In 1969, BSC introduced a new class of cars for Trailer Train known as the "F68BH" class.

The F68BH cars had steel decks, transverse deck risers, and a MacLean-Fogg transverse tie-down apparatus. They also had upright "finger racks" near each end, which helped secure their intended lading of concrete reinforcing bar, or "rebar." Due to their distinctive finger racks, these flats became known as "candelabra cars."

The 100-ton cars came equipped with 36" wheels, trucks with hydraulic snubbers at opposite corners, and 15" EOCC to improve ride quality and reduce dangerous shifting loads. Between December 1969 and February 1970, BSC built 150 F68BH cars. Initially, these cars were used for rebar service out of Bethlehem Steel's Steelton, PA facility and could be seen hauling rebar nationwide.

ROADNAME AND ROAD NUMBER SPECIFIC SCALETRAINS

- **All New Model**
- **First time in HO scale**
- **Multiple road numbers per paint scheme**
- **Factory-applied finger rack details**
- **MacLean-Fogg tie-down details on decks**
- **Deck with transverse risers**
- **Early H-shaped jacking pads**
- **Vertical handbrake staff**
- **Finely detailed brake linkage, triple valve, cylinder, and actuator**
- **Factory-applied trainline pipe**
- **Durable die-cast metal semi-scale long-shank Type E couplers**
- **100-ton trucks with hydraulic snubber and bracket details, rotating bearing caps, and truck-mounted brake beams**
- **36" Machined metal wheels**
- **Minimum radius: 18"**
- **Recommended radius: 22"**
- **Fully assembled**
- **Color matched to Tru-Color paint colors when possible**
- **Printing and lettering legible under magnification**
- **Accurately profiled .110" wide wheel tread**
- **Coupler cut levers**
- **Trainline hoses**
- **Intricate brake plumbing**
- **Weighted to Industry standards**
- **Operates on Code 70, 83 and 100 rail**
- **Packaging safely stores model**

ScaleTrains • 4901 Old Tasso Rd NE, Cleveland, TN 37312 • www.ScaleTrains.com
Toll-Free 844-9TRAINS • International 423-299-3689

WARNING: This product may contain a chemical known to the State of California to cause cancer or birth defects or other reproductive harm.
© 2023 ScaleTrains.com, Inc., ScaleTrains, Rivet Counter and respective logos and slogans are trademarks of ScaleTrains.com, Inc.



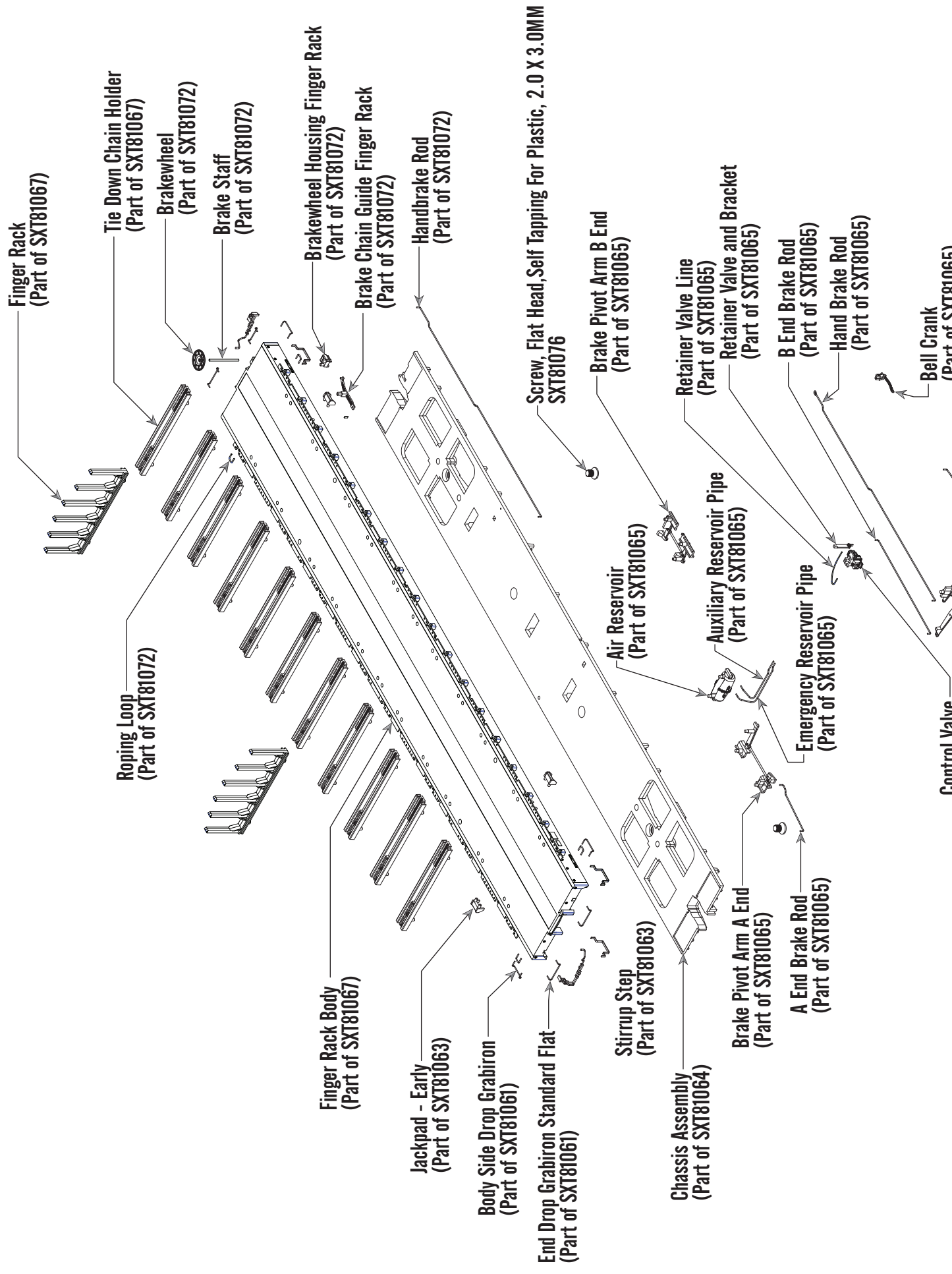

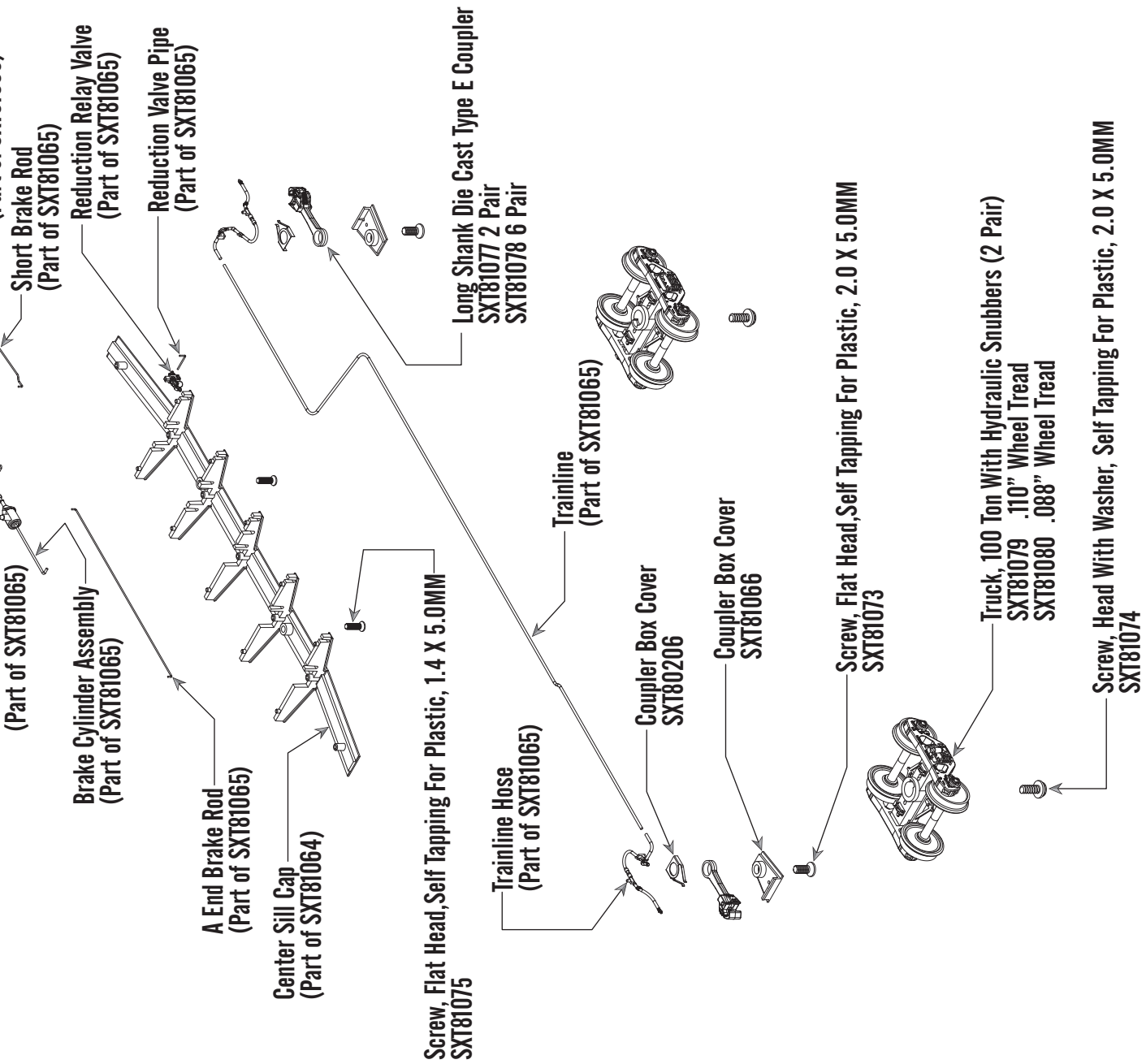

RIVET COUNTER BETHLEHEM STEEL F68BH FINGER RACK FLAT PARTS LIST

SXT81352 Instruction Sheet
SXT81061 Grab Iron Set
SXT81063 Body Detail Set
SXT81064 Chassis Assembly
SXT81065 Bulkhead Brake Details Set
SXT81066 Coupler Box Cover
SXT81067 Finger Rack Body Assembly

SXT81072 Standard Flat Car Specific Detail Set
SXT81073 Screw, Flat Head, Self Tapping For Plastic 2.0MM X 5.0MM
SXT81074 Screw, Head With Washer, Machine 2.0MM X 5.0MM
SXT81075 Screw, Flat Head, Self Tapping For Plastic 2.0MM X 3.0M
SXT81076 Screw, Flat Head, Self Tapping For Plastic 1.4MM X 5.0MM
SXT81079 100 Ton Trucks W/ Hydraulic Snubber with 36" Wheels

For a list of parts included in each parts set, see the exploded view.

ADDITIONAL PARTS AVAILABLE

SXT81077 Long Shank Type E Coupler, Diecast 2-Pair
SXT81078 Long Shank Type E Coupler, Diecast 6-Pair
SXT80205 Coupler Centering Spring
SXT80206 Coupler Knuckle Spring

SXT81080 Truck Assembly, 100 Ton With Hydraulic Snubber,
.088" Tread - Rivet Counter (2 Pair)
SXT80211 Rivet Counter Wheelset 36" .088" Tread - 8 Pack
SXT80212 Rivet Counter Wheelset 36" .110" Tread - 8 Pack



PRODUCT SUPPORT

U.S. 844-9TRAINS; 844-987-2467 Ext. 2
International 423-299-3689
Support@ScaleTrains.com



www.ScaleTrains.com

SIGNUP FOR OUR WEEKLY NEWSLETTER

www.ScaleTrains.com/newsletter



ScaleTrains

4901 Old Tasso Rd NE,
Cleveland, TN 37312 USA



FOLLOW SCALETRAINS



WARRANTY POLICY

ScaleTrains.com, Inc. (ScaleTrains) warrants products purchased from our website to be free from defects in material and workmanship for a period of two (2) years from the date of purchase. Products purchased directly from ScaleTrains are automatically registered and a receipt is not required for proof of purchase.

ScaleTrains warrants products purchased from an authorized Select Retailer to be free from defects in material and workmanship for a period of one (1) year from the date of purchase. The warranty period can be extended to two (2) years by registering the product within 30 days of purchase on our website at www.ScaleTrains.com/warranty. Be sure to retain the receipt as proof of purchase as it may be required in the event your model requires warranty service by our Service Center.

If the product fails during the limited warranty period, carefully pack the model in the original packaging. Be sure to include an explanation of the issue(s) along with your name, address, phone and email. If the product(s) were purchased from a Select Retailer, include a legible copy of the sales receipt.

Ship item(s) for repair to our Service Center at...

ScaleTrains Service Center
4901 Old Tasso Road NE
Cleveland, TN 37312

We recommend using a trackable shipping service. Shipping damage incurred on the way to our service center and costs associated with shipping are not covered under warranty.

Damages due to improperly storing, handling, or packaging are not covered under warranty.

If ScaleTrains.com deems the product to be defective, we will either (1) repair (2) replace the item, or (3) offer a store credit redeemable at ScaleTrains.com toward a future purchase. This determination is at the sole discretion of ScaleTrains.

ScaleTrains has the final decision on all warranty matters. The warranty policy is subject to change without notice.