



RIVET COUNTER HO SCALE GUNDERSON MULT-MAX AUTORACK

Our **Rivet Counter™** brand strives to create the most accurately detailed model trains imaginable. The real-world counterpart is meticulously researched to ensure prototype fidelity. Each model features numerous factory applied parts including **railroad, road number, and era-specific™** details whenever possible.

In 2013, Greenbrier/Gunderson introduced a new design called "Multi-Max" that aimed to provide the ultimate protection for vehicles and operational flexibility. This design addressed challenges faced by railroads and shippers in the 21st century. The traditional enclosed autorack used to protect new autos from projectiles could not prevent graffiti. Paint spray would pass through the perforations in the side panels and onto the new automobiles, ruining their finish. Multi-Max reduced the chance of paint spray passing through by featuring smaller, fewer, and more widely spaced perforations in its side panels.

Multi-Max also has an innovative design feature, being able to adjust the number of decks for automobiles of different heights. Bi-level autoracks are intended to carry taller vehicles like SUVs or vans, while tri-level autoracks, with an additional deck, handle shorter-in-height standard or compact autos in the same given space. The ability for railroad car shops to change the car configuration from bi-level to tri-level, or vice-versa, as traffic patterns dictate, eliminates the need to order bi- and/or tri-level racks based upon anticipated traffic from manufacturing plants. This feature is beneficial when production shifts from one vehicle type to another, resulting in a surplus of car types unsuitable for the new traffic.

ROADNAME AND ROAD NUMBER SPECIFIC SCALETRAINS

- All new model
- Car rack numbers and ARR rack clearance data is specific to each car number
- 14 photo etched metal side panels
- Rivet details on colored panels represent either bilevel or trilevel versions
- Separate door rods
- All-metal Type E extended shank couplers
- All-new ASF low deck swing motion trucks with rotating axle bearing caps
- 28" machined metal wheels
- Highly detailed underbody brake system with wire form brake rods and air line plumbing, photo etched metal brake rod and air line plumbing support brackets; plastic brake beams, air reservoir, brake cylinder, control valve and retainer valve
- Photo etched metal defect card holder
- Minimum radius 24", recommended radius 26"
- Fully assembled
- Color matched to Tru-Color paint colors when possible
- Photo-etched stainless steel see-through end crossover platforms
- Printing and lettering legible under magnification
- Accurately profiled .110" wide wheel tread
- Coupler cut levers
- Trainline hoses
- Intricate brake plumbing
- Weighted to Industry standards
- Operates on Code 70, 83 and 100 rail
- Packaging safely stores model

ScaleTrains • 4901 Old Tasso Rd NE, Cleveland, TN 37312 • www.ScaleTrains.com
Toll-Free 844-9TRAINS • International 423-299-3689

WARNING: This product may contain a chemical known to the State of California to cause cancer or birth defects or other reproductive harm.
© 2023 ScaleTrains.com, Inc., ScaleTrains, Rivet Counter and respective logos and slogans are trademarks of ScaleTrains.com, Inc.



SXT81312

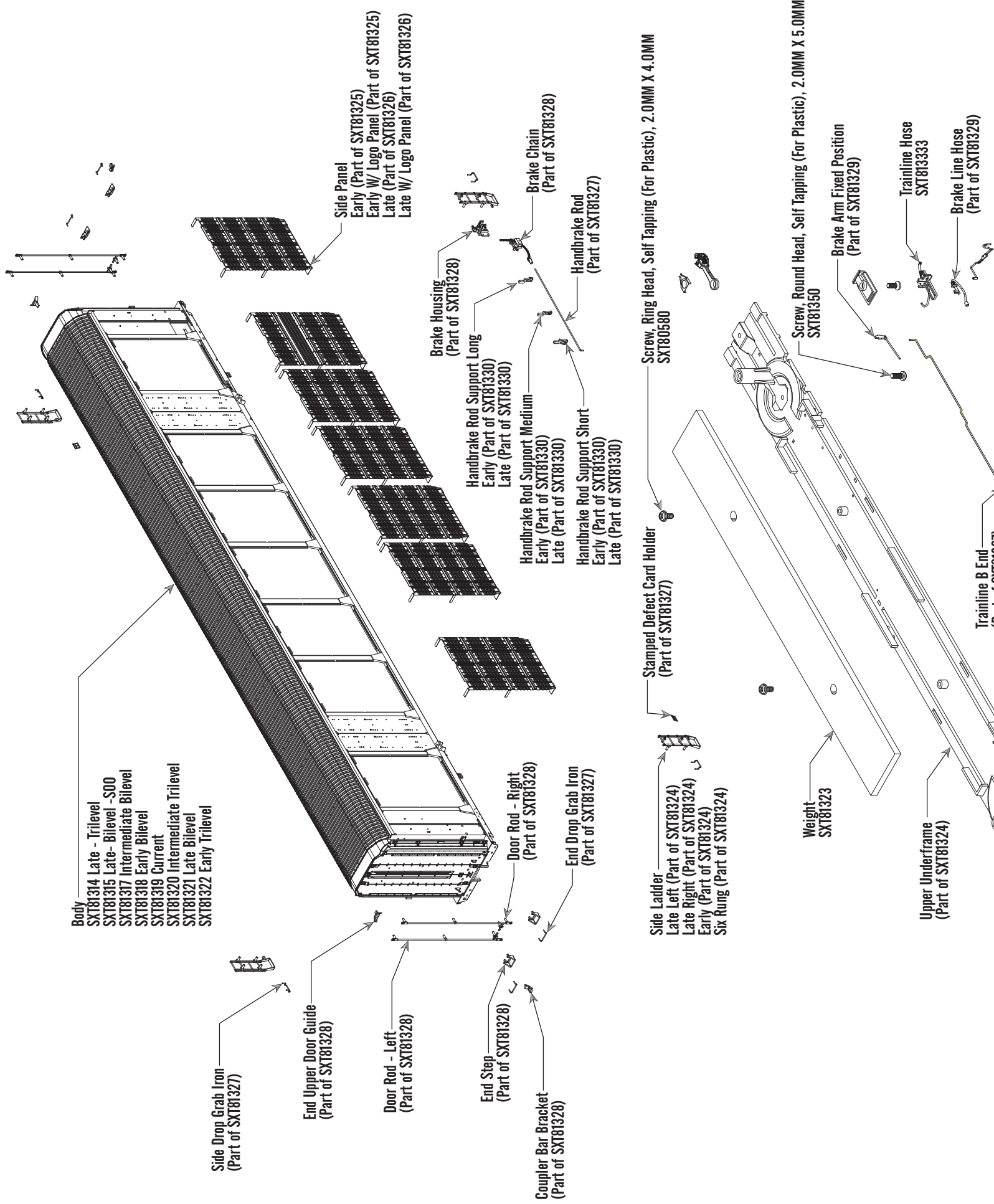

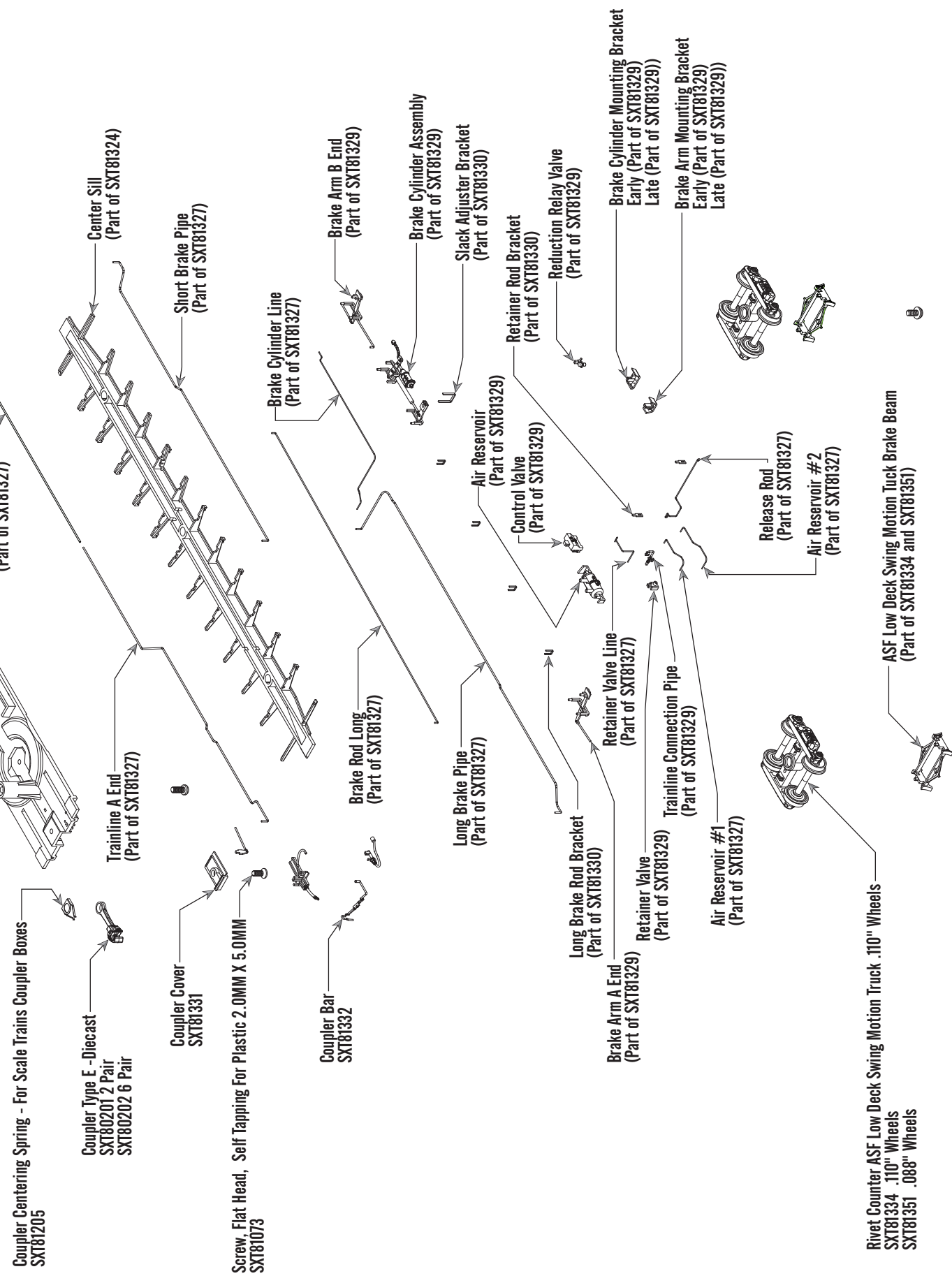

RIVET COUNTER HO SCALE GUNDERSON MULTIMAX AUTORACK PARTS LIST

SXT81312 Instruction Sheet
SXT81314 Body - Late Trilevel
SXT81315 Body - Late Bilevel - Soo
SXT81317 Body - Intermediate Bilevel
SXT81318 Body - Early Bilevel
SXT81319 Body - Current
SXT81320 Body - Intermediate Trilevel
SXT81321 Body - Late Bilevel
SXT81322 Body - Early Trilevel
SXT81323 Weight
SXT81324 Underframe Assembly
SXT81325 Side Panel Set - Early

SXT81326 Side Panel Set - Others
SXT81327 Wire Form Set
SXT81328 Body Detail Set
SXT81329 Brake Parts Set - Plastic
SXT81330 Metal Parts Set
SXT81331 Coupler Cover
SXT81332 Coupler Bar
SXT81333 Train Line Hose
SXT81334 ASF Low Deck Swing Motion Truck .110" Wheels
SXT80580 Screw, Ring Head, Self Tapping (For Plastic), 2.0MM X 4.0MM
SXT81073 Screw, Flat Head, Self Tapping (For Plastic) 2.0MM X 5.0MM

For a list of parts included in each parts set, see the exploded view.

ADDITIONAL PARTS AVAILABLE

SXT81077 Long Shank Type E Coupler - Die Cast 2 pr.
SXT81078 Long Shank Type E Coupler - Die Cast 6 pr.
SXT80805 Coupler Center Spring
SXT80206 Coupler Knuckle Spring

SXT81351 Rivet Counter ASF Low Deck Swing Motion Truck .088" Wheels (2 Pair)
SXT81336 Rivet Counter Wheelset 28" .088" Tread - 8 Pack
SXT81335 Rivet Counter Wheelset 28" .110" Tread - 8 Pack



PRODUCT SUPPORT

U.S. 844-9TRAINS; 844-987-2467 Ext. 2
International 423-299-3689
Support@ScaleTrains.com



www.ScaleTrains.com

SIGNUP FOR OUR WEEKLY NEWSLETTER
www.ScaleTrains.com/newsletter



ScaleTrains

4901 Old Tasso Rd NE,
Cleveland, TN 37312 USA



FOLLOW SCALETRAINS



WARRANTY POLICY

ScaleTrains.com, Inc. (ScaleTrains) warrants products purchased from our website to be free from defects in material and workmanship for a period of two (2) years from the date of purchase. Products purchased directly from ScaleTrains are automatically registered and a receipt is not required for proof of purchase.

ScaleTrains warrants products purchased from an authorized Select Retailer to be free from defects in material and workmanship for a period of one (1) year from the date of purchase. The warranty period can be extended to two (2) years by registering the product within 30 days of purchase on our website at www.ScaleTrains.com/warranty. Be sure to retain the receipt as proof of purchase as it may be required in the event your model requires warranty service by our Service Center.

If the product fails during the limited warranty period, carefully pack the model in the original packaging. Be sure to include an explanation of the issue(s) along with your name, address, phone and email. If the product(s) were purchased from a Select Retailer, include a legible copy of the sales receipt.

Ship item(s) for repair to our Service Center at...

ScaleTrains Service Center
4901 Old Tasso Road NE
Cleveland, TN 37312

We recommend using a trackable shipping service. Shipping damage incurred on the way to our service center and costs associated with shipping are not covered under warranty.

Damages due to improperly storing, handling, or packaging are not covered under warranty.

If ScaleTrains.com deems the product to be defective, we will either (1) repair (2) replace the item, or (3) offer a store credit redeemable at ScaleTrains.com toward a future purchase. This determination is at the sole discretion of ScaleTrains.

ScaleTrains has the final decision on all warranty matters. The warranty policy is subject to change without notice.