



PRODUCT MANUAL



OPERATOR HO SCALE P-S 4785 COVERED HOPPER

Operator™ trains are built for modelers who enjoy running high-quality, realistic trains at an affordable price. Designed from builder's drawings and photographs, Operator models have fewer factory-applied parts and simplified printing. For added versatility, super-detail parts are available separately.

Introduced in 1967, the PS-2CD 4785 cubic foot covered hopper was designed for various commodities, such as grain, chemicals, or minerals. Manufactured in the Butler, Pennsylvania, design improvements were implemented throughout its five-year production period. The end "cages" of the cars changed, and tall shear plates were added to the end sills for later production models. Customers could choose from different roof hatch options, including full-length trough, three-trough, or round hatches.

The full-length trough was suitable for grain duty, while the round hatches were preferred for commodities that needed better protection. The three-trough option, which was unique to Cotton Belt, combined the benefits of the full-length trough and round hatch. Different outlet types and brands, such as gravity or gravity-pneumatic, could be fitted to handle different commodities. Gravity outlets were used for grains, while gravity-pneumatic outlets provided greater flexibility for commodities like plastic pellets or powdery chemicals. Running board and end coupler platforms could also vary, with Apex, Morton, or U.S. Gypsum types available.

For over half a century, these innovative cars have crisscrossed North America in singles and groups of covered hoppers. Many continue in revenue service well into the 2020s, with some finding a second life in leaser service.

PROTOTYPE SPECIFIC SCALETRAINS

- **All-new model**
- **Four different road numbers**
- **Continuous trough hatch with ribs**
- **Molded Apex (slotted) walkways and coupler platforms**
- **Tall end vertical grab supports**
- **Tall vertical end supports**
- **Gravity outlets with short tracks**
- **Factory-applied ladders**
- **Air reservoir and control valve details**
- **Molded trainline piping**
- **Handbrake is mounted on the tall end vertical supports**
- **Highly-detailed one-piece Barber S-2 100-ton trucks**
- **36" Machined metal wheels**
- **Minimum radius: 18"**
- **Recommended radius: 22"**
- **Factory assembled**
- **When possible color matched to Tru-Color paint colors**
- **Printing and lettering legible under magnification**
- **Simplified underbody brake rigging**
- **Body mounted semi-scale knuckle couplers**
- **Accurately profiled .110" wide wheel tread**
- **Weighted to Industry standards**
- **Operates on Code 70, 83 and 100 rail**
- **Packaging safely stores model**

ScaleTrains • 4901 Old Tasso Rd NE, Cleveland, TN 37312 • www.ScaleTrains.com
Toll-Free 844-9TRAINS • International 423-299-3689

WARNING: This product may contain a chemical known to the State of California to cause cancer or birth defects or other reproductive harm.
© 2023 ScaleTrains.com, Inc., ScaleTrains, Rivet Counter and respective logos and slogans are trademarks of ScaleTrains.com, Inc.



SXT80659

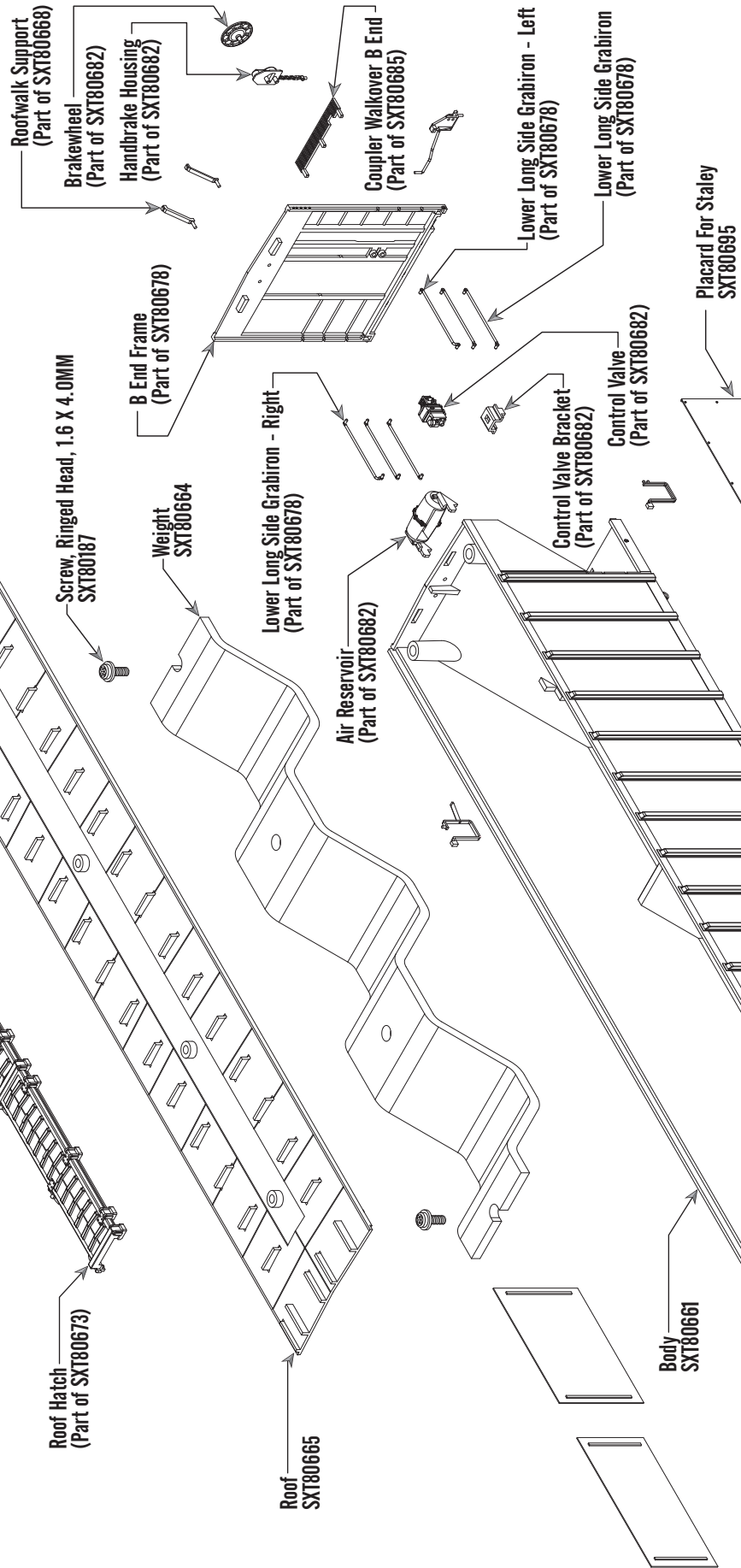
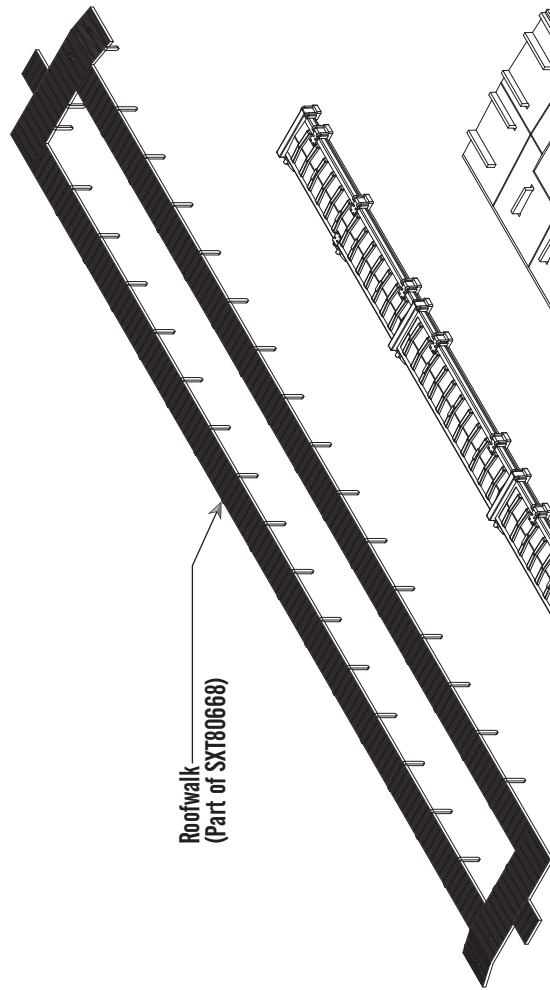

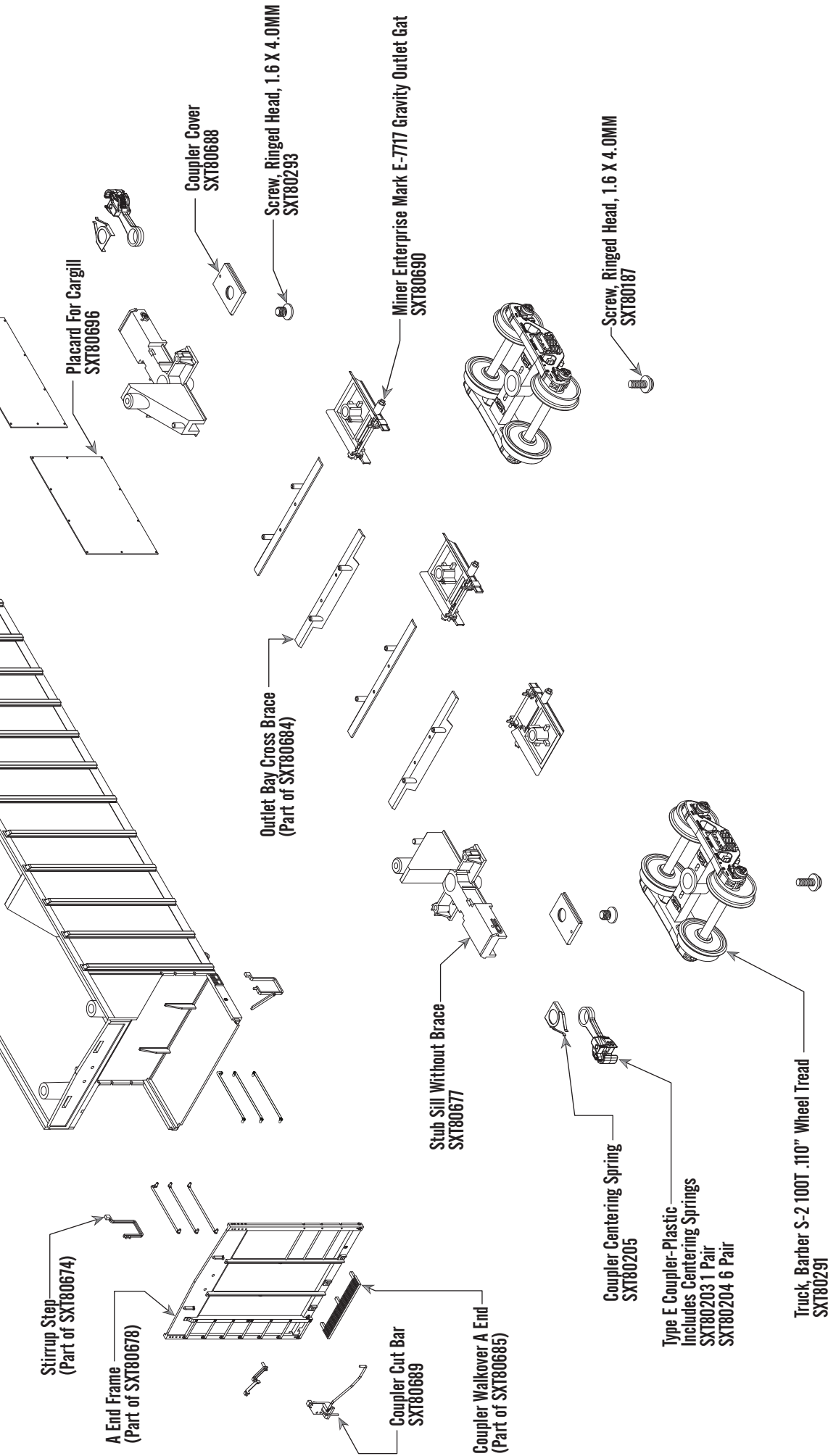

OPERATOR HO SCALE P-S 4785 COVERED HOPPER PARTS LIST

SXT80659 Instruction Sheet
SXT80661 Body Assembly
SXT80664 Weight
SXT80665 Roof - Trough
SXT80668 Roofwalk
SXT80673 Roof Hatch Set
SXT80674 Single Stirrup Step Set
SXT80678 End Cage Set
SXT80682 Brake Detail Set
SXT80684 Underbody Detail Set
SXT80685 Coupler Walkover Set
SXT80688 Coupler Cover

SXT80689 Coupler Cut Bar
SXT80690 Miner Enterprise Mark E-7717 Gravity Outlet Gate
SXT80695 Placard for Staley Car
SXT80696 Placard for Cargill Car
SXT80291 Truck Assembly, Barber S-2 100 Ton Truck .100" Tread
SXT80187 Screw, Ringed Head, 1.6 X 4.0MM (Truck and Weight Screw)
SXT80293 Screw, Flat Head 2.0 X 3.0MM (Coupler Box Cover)
SXT80168 Type E Coupler, Plastic 2 Pair
SXT80169 Type E Coupler, Plastic 6 Pair
SXT80205 Coupler Centering Spring
SXT80206 Coupler Knuckle Spring

For a list of parts included in each parts set, see the exploded view.

ADDITIONAL PARTS AVAILABLE

SXT80655 Detail Upgrade Kit - Set includes: Roofwalk Grabirons, Lower Side Grabirons (left and right), Trainline, Brakeline, Trainline / Brakeline Brackets, Trainline Hose, End Long Grabiron, End Long Grabiron Bracket, Release Rod, Release Rod Support and Bellcrank.



PRODUCT SUPPORT

U.S. 844-9TRAINS; 844-987-2467 Ext. 2
International 423-299-3689
Support@ScaleTrains.com



ScaleTrains

4901 Old Tasso Rd NE,
Cleveland, TN 37312 USA



www.ScaleTrains.com

SIGNUP FOR OUR WEEKLY NEWSLETTER

www.ScaleTrains.com/newsletter



FOLLOW SCALETRAINS



WARRANTY POLICY

ScaleTrains.com, Inc. (ScaleTrains) warrants products purchased from our website to be free from defects in material and workmanship for a period of two (2) years from the date of purchase. Products purchased directly from ScaleTrains are automatically registered and a receipt is not required for proof of purchase.

ScaleTrains warrants products purchased from an authorized Select Retailer to be free from defects in material and workmanship for a period of one (1) year from the date of purchase. The warranty period can be extended to two (2) years by registering the product within 30 days of purchase on our website at www.ScaleTrains.com/warranty. Be sure to retain the receipt as proof of purchase as it may be required in the event your model requires warranty service by our Service Center.

If the product fails during the limited warranty period, carefully pack the model in the original packaging. Be sure to include an explanation of the issue(s) along with your name, address, phone and email. If the product(s) were purchased from a Select Retailer, include a legible copy of the sales receipt.

Ship item(s) for repair to our Service Center at...

ScaleTrains Service Center
4901 Old Tasso Road NE
Cleveland, TN 37312

We recommend using a trackable shipping service. Shipping damage incurred on the way to our service center and costs associated with shipping are not covered under warranty.

Damages due to improperly storing, handling, or packaging are not covered under warranty.

If ScaleTrains.com deems the product to be defective, we will either (1) repair (2) replace the item, or (3) offer a store credit redeemable at ScaleTrains.com toward a future purchase. This determination is at the sole discretion of ScaleTrains.

ScaleTrains has the final decision on all warranty matters. The warranty policy is subject to change without notice.