



PRODUCT MANUAL



OPERATOR HO SCALE GUNDERSSON 5188 COVERED HOPPER

Operator™ trains are built for modelers who enjoy running high-quality, realistic trains at an affordable price. Designed from builder's drawings and photographs, Operator models have fewer factory-applied parts and simplified printing. For added versatility, super-detail parts are available separately.

Railroads often transport grain in single cars or unit trains of covered hoppers. To make handling more efficient, designs have improved over time. One popular design is the Gunderson-GIMSA/Concarril 5188cf Covered Hopper. This

hopper is a large 3-bay car that measures 58' and can hold 5,188 cubic feet. It has trough-style loading hatches and metal or non-metal hatch covers. Each bay has a 30" x 30" outlet that can be customized for different commodities. The design has gone through changes since production began in 2007, including adjustments to the car sides, ribs, and pulling loops.

PROTOTYPE SPECIFIC SCALETRAINS

- **All-new model**
- **Molded end cage**
- **Metal type roof hatches**
- **ATP 30 X 30 Outlets**
- **Triple valve, cylinder, and actuator**
- **Highly-detailed, one-piece ASF Motion Control Trucks**
- **36" Machined metal wheels**
- **Molded trainline pipe**
- **Minimum radius: 18"**
- **Recommended radius: 22"**
- **Factory assembled**
- **Color matched to Tru-Color paint colors**
- **Printing and lettering legible under magnification**
- **Simplified underbody brake rigging**
- **Body mounted semi-scale knuckle couplers**
- **Accurately profiled .110" wide wheel tread**
- **Weighted to Industry standards**
- **Operates on Code 70, 83 and 100 rail**
- **Packaging safely stores model**

ScaleTrains • 4901 Old Tasso Rd NE, Cleveland, TN 37312 • www.ScaleTrains.com
Toll-Free 844-9TRAINS • International 423-299-3689

WARNING: This product may contain a chemical known to the State of California to cause cancer or birth defects or other reproductive harm.
© 2023 ScaleTrains.com, Inc., ScaleTrains, Rivet Counter and respective logos and slogans are trademarks of ScaleTrains.com, Inc.



SXT80623

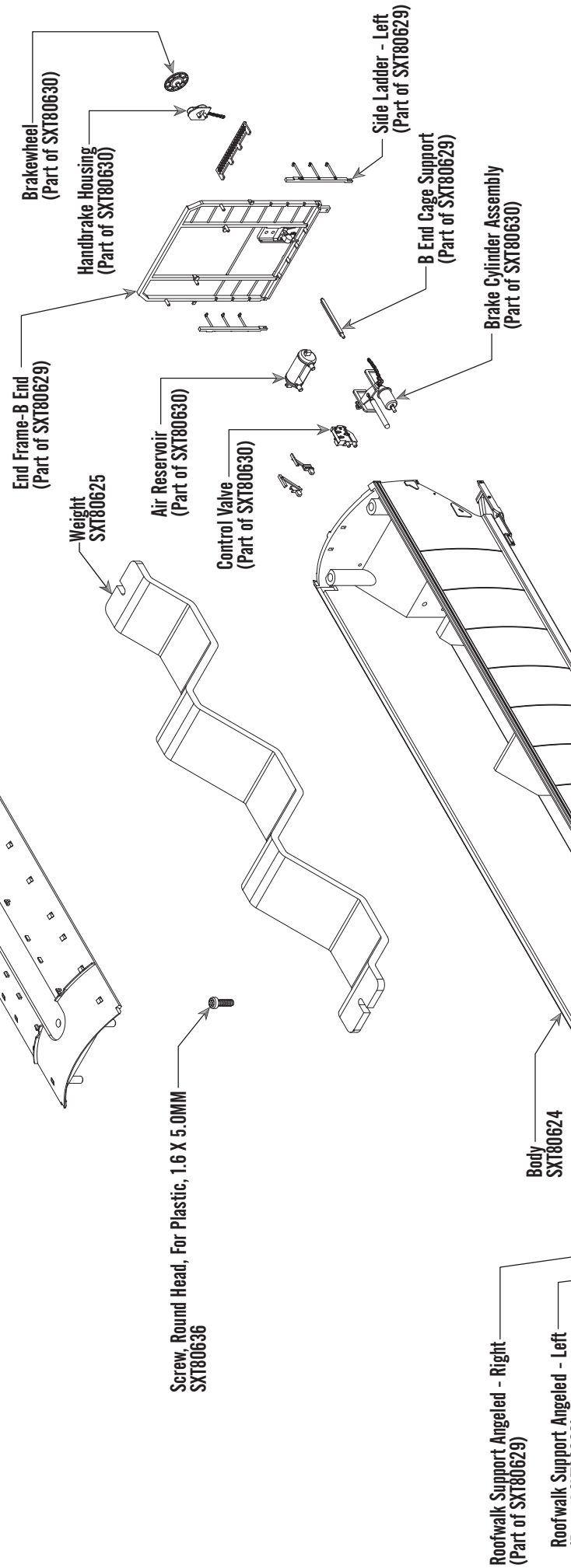
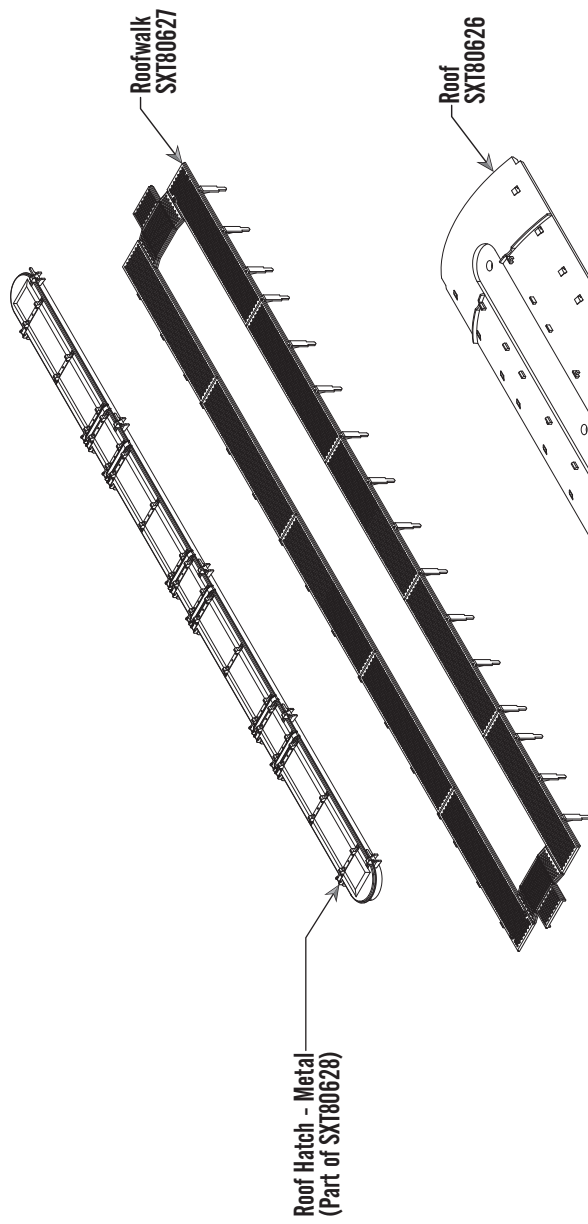

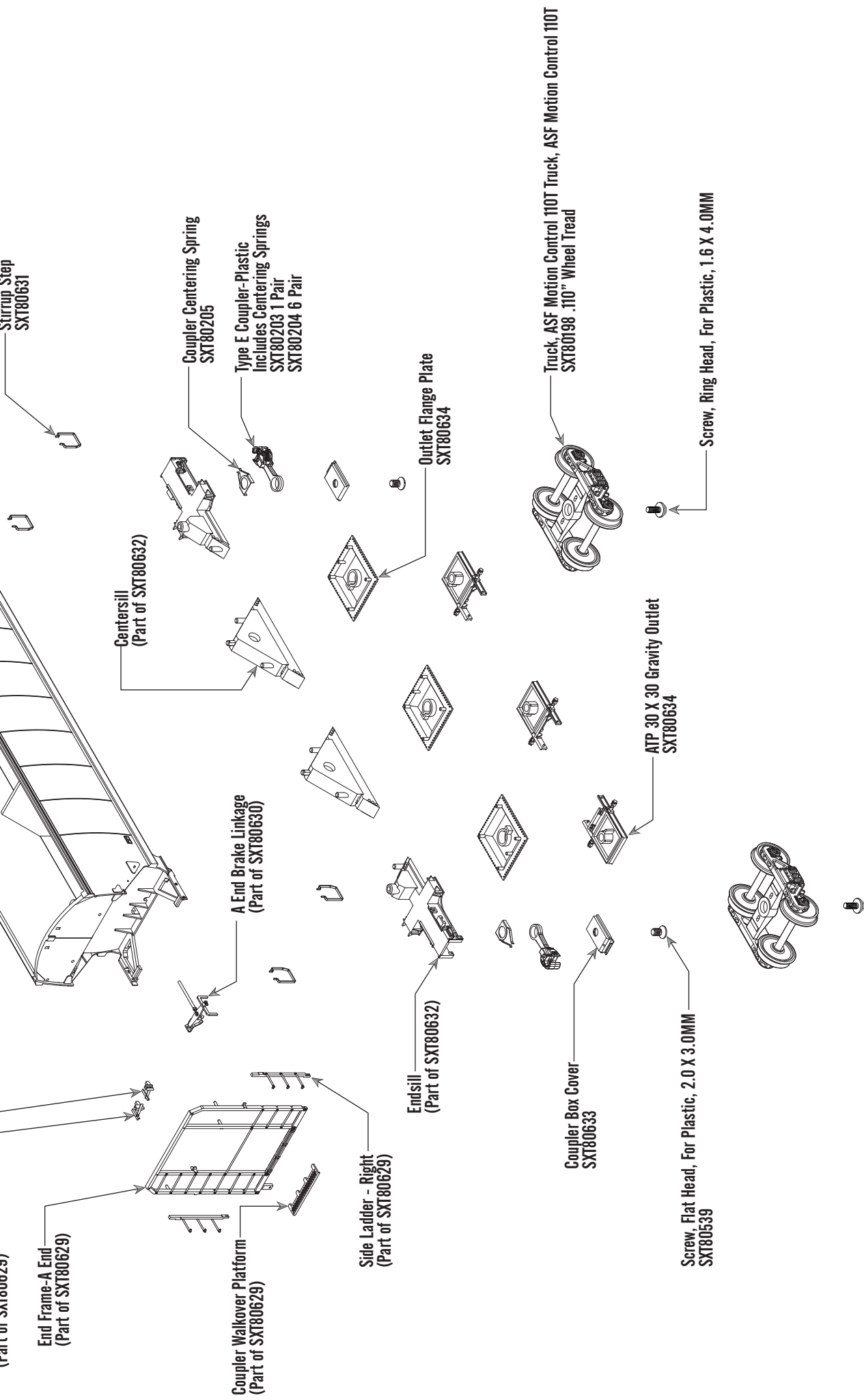

OPERATOR HO SCALE GUNDERSSON 5188 COVERED HOPPER PARTS LIST

SXT80623 Instruction Sheet
SXT80624 Body
SXT80625 Weight
SXT80626 Roof
SXT80627 Roofwalk, Plastic
SXT80628 Roof Hatch Set
SXT80629 End Cage Assembly Set
SXT80630 Brake Detail Set
SXT80631 Stirrup Step
SXT80632 Centersill Set
SXT80633 Coupler Box Cover

SXT80634 Outlet Flange Plate
SXT80635 ATP 30 X 30 Gravity Outlet
SXT80636 Screw, Round Head, For Plastic, 1.6 X 5.0MM
SXT80539 Screw, Flat Head, For Plastic, 2.0 X 3.0MM
SXT80187 Screw, Ring Head, For Plastic, 1.6 X 4.0MM
SXT80198 Truck, ASF Motion Control 110T, .110" Wheel Tread
SXT80168 Type E Coupler, Plastic 2 Pair
SXT80169 Type E Coupler, Plastic 6 Pair
SXT80205 Coupler Centering Spring
SXT80206 Coupler Knuckle Spring

For a list of parts included in each parts set, see the exploded view.

ADDITIONAL PARTS AVAILABLE

SXT80521 Operator Upgrade Kit



PRODUCT SUPPORT

U.S. 844-9TRAINS; 844-987-2467 Ext. 2
International 423-299-3689
Support@ScaleTrains.com



ScaleTrains

4901 Old Tasso Rd NE,
Cleveland, TN 37312 USA



www.ScaleTrains.com

SIGNUP FOR OUR WEEKLY NEWSLETTER

www.ScaleTrains.com/newsletter

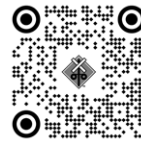

FOLLOW SCALETRAINS



WARRANTY POLICY

ScaleTrains.com, Inc. (ScaleTrains) warrants products purchased from our website to be free from defects in material and workmanship for a period of two (2) years from the date of purchase. Products purchased directly from ScaleTrains are automatically registered and a receipt is not required for proof of purchase.

ScaleTrains warrants products purchased from an authorized Select Retailer to be free from defects in material and workmanship for a period of one (1) year from the date of purchase. The warranty period can be extended to two (2) years by registering the product within 30 days of purchase on our website at www.ScaleTrains.com/warranty. Be sure to retain the receipt as proof of purchase as it may be required in the event your model requires warranty service by our Service Center.

If the product fails during the limited warranty period, carefully pack the model in the original packaging. Be sure to include an explanation of the issue(s) along with your name, address, phone and email. If the product(s) were purchased from a Select Retailer, include a legible copy of the sales receipt.

Ship item(s) for repair to our Service Center at...

ScaleTrains Service Center
4901 Old Tasso Road NE
Cleveland, TN 37312

We recommend using a trackable shipping service. Shipping damage incurred on the way to our service center and costs associated with shipping are not covered under warranty.

Damages due to improperly storing, handling, or packaging are not covered under warranty.

If ScaleTrains.com deems the product to be defective, we will either (1) repair (2) replace the item, or (3) offer a store credit redeemable at ScaleTrains.com toward a future purchase. This determination is at the sole discretion of ScaleTrains.

ScaleTrains has the final decision on all warranty matters. The warranty policy is subject to change without notice.