



OPERATOR HO SCALE GATC 4180 AIRSLIDE

Operator™ trains are built for modelers who enjoy running high-quality, realistic trains at an affordable price. Designed from builder's drawings and photographs, Operator models have fewer factory-applied parts and simplified printing. For added versatility, super-detail parts are available separately.

GATC introduced the 4180 Cubic Foot Airslide® covered hopper in 1963, with a patented "Airslide" unloading system designed for commodities like flour and sugar. The system uses pressurized air to fluidize the commodity and aid unloading. Production of the 4180cf Airslide continued until

1980 when it was replaced by larger designs such as the 4566cf Airslide.

The 4566 was built in 1978 for bulk commodities like chemicals, starch, sugar, and flour. Nearly 1,000 4566 Airslides were built for various customers before production ended in 1985. Nowadays, some 4566s continue to serve their original purpose, while others have been relegated to buffer service for crude oil and ethanol unit trains after being replaced by larger volume covered hopper designs.

PROTOTYPE SPECIFIC SCALETRAINS

- **Officially licensed by GATX**
- **GATX provided original blueprint copies**
- **All-new model**
- **Represents phase "TZL" 4180cf Airslide**
- **Multiple road numbers**
- **Finely detailed gravity outlets**
- **Separately-applied Airslide plumbing**
- **Highly-detailed, one-piece Barber S-2 100-ton trucks**
- **36" Machined metal wheels**
- **Starter dimples for modeler-applied grab irons, uncoupling levers, and train line hoses available separately**
- **Detail upgrade kit - Includes Grabirons, trainline, trainline support brackets, brake rods, brakeroad support brackets, Air Reservoir lines, Trainline hoses and Coupler cut lever and bracket. Sold separately**
- **Decal upgrade sheet - (For first production run) - Sheet includes various data that is not on the Operator version of these cars. The sheet will include data for all cars in the first run.**
- **Minimum radius: 18"**
- **Recommended radius: 22"**
- **Factory assembled**
- **Color matched to Tru-Color paint colors**
- **Printing and lettering legible under magnification**
- **Simplified underbody brake rigging**
- **Body mounted semi-scale knuckle couplers**
- **Accurately profiled .110" wide wheel tread**
- **Weighted to Industry standards**
- **Operates on Code 70, 83 and 100 rail**
- **Packaging safely stores model**

ScaleTrains • 4901 Old Tasso Rd NE, Cleveland, TN 37312 • www.ScaleTrains.com
Toll-Free 844-9TRAINS • International 423-299-3689

WARNING: This product may contain a chemical known to the State of California to cause cancer or birth defects or other reproductive harm.
© 2023 ScaleTrains.com, Inc., ScaleTrains, Rivet Counter and respective logos and slogans are trademarks of ScaleTrains.com, Inc.

Roofwalk Set

SXT80275

Set Includes

Roofwalk

Roofwalk Grabiron (2)

Roofwalk Support (2)

Roofwalk Grabiron
(Part of SXT80275)

Roof Hatch
SXT80270

Roofwalk
(Part of SXT80275)

Screw, Ringed Head
SXT80292

Weight
SXT80269

Roof
SXT80266 Early - For Morton Roofwalk

Roofwalk Support
(Part of SXT80275)

Brakewheel
(Part of SXT80276)

Handbrake Housing
(Part of SXT80276)

Handbrake Housing Mounting Bracket
(Part of SXT80276)

Body
SXT80263

Trough Plate, Outer
(Part of SXT80277)

Outlet Handle
(Part of SXT80277)

Trough Plate, Inner
(Part of SXT80277)

Coupler Walkover Platform
(Part of SXT80281)

Outlet Piping and Brackets
(Part of SXT80277)

Trough Plate and Outlet Set
SXT80277

Set Includes

Trough Plate, Outer (4)

Trough Plate, Inner (4)

Outlet, Gravity (4)

Outlet, Gravity Pneumatic (2)

Outlet Hose (4)

Coupler Walkover Platform Set
SXT80281
Set Includes
Coupler Walkover Platform, B End
Coupler Walkover Platform, A End

Outlet Handle (4)
Outlet Piping - 4180 OP (4)

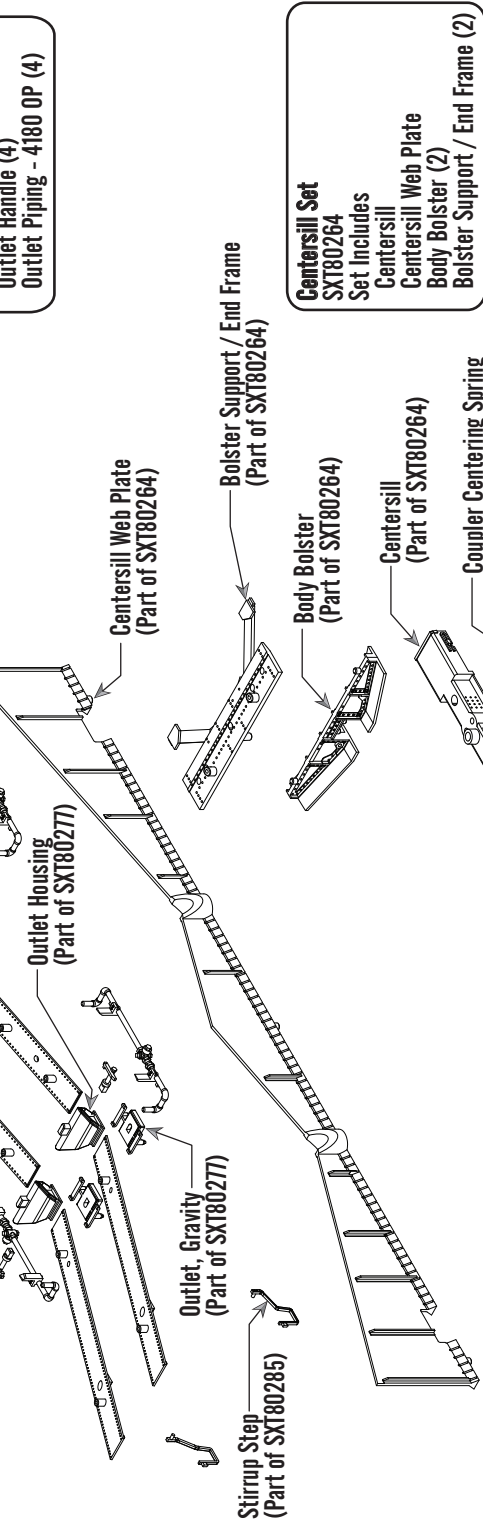

Stirrup Step Set
SXT80285
Set Includes
Stirrup Step, Early - Left (2)
Stirrup Step, Early - Right (2)

Centersill Set
SXT80264
Set Includes
Centersill
Centersill Web Plate
Body Bolster (2)
Bolster Support / End Frame (2)

Truck, Barber S-2 100T .110" Wheel Tread
SXT80291

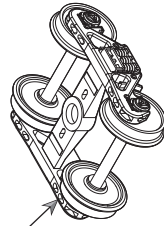

Brake Parts Detail Set, Plastic
SXT80276

Set Includes
Brakewheel
Brake Cylinder and Linkage, Short
Handbrake Housing Mounting Bracket, Early (Solid)
Air Reservoir
Handbrake Housing
Lateral Underframe Support Brace
Control Valve
Retainer Valve and Bracket, Early

OPERATOR HO SCALE GATC 4180 AIRSLIDE PARTS LIST

SXT80257 Instruction Sheet
SXT80263 Body Assembly
SXT80264 Centersill Set
SXT80275 Roofwalk Set, Morton
SXT80276 Brake Parts Detail Set, Plastic
SXT80277 Trough Plate and Outlet Set
SXT80281 Coupler Walkover Platform Set
SXT80285 Stirrup Step Set
SXT80291 Truck Assembly, Barber S-2 100 Ton
Truck .100" Tread

SXT80187 Screw, Ringed Head, 1.6 X 4.0MM (Truck Screw)
SXT80292 Screw, Ringed Head, 2.0 X 3.5MM (For Weight)
SXT80293 Screw, Flat Head 2.0 X 3.0MM (Coupler Box Cover)
SXT80168 Type E Coupler, Plastic 2 Pair
SXT80169 Type E Coupler, Plastic 6 Pair
SXT80205 Coupler Centering Spring
SXT80206 Coupler Knuckle Spring

For a list of parts included in each parts set, see the exploded view.

ADDITIONAL PARTS AVAILABLE

SXT80251 Detail Upgrade Kit - Set includes:
Grabirons, trainline, trainline
support brackets, brake rods,
brakerod support brackets, Air
Reservoir lines, Trainline hoses and
Coupler cut lever and bracket.

SXT80252 Decal Upgrade Sheet (For first production run) - Sheet
includes various data that is not on the Operator version
of these cars. The sheet will include data for all cars in
the first run.



PRODUCT SUPPORT

U.S. 844-9TRAINS; 844-987-2467 Ext. 2
International 423-299-3689
Support@ScaleTrains.com



ScaleTrains

4901 Old Tasso Rd NE,
Cleveland, TN 37312 USA



www.ScaleTrains.com

SIGNUP FOR OUR WEEKLY NEWSLETTER

www.ScaleTrains.com/newsletter



FOLLOW SCALETRAINS



WARRANTY POLICY

ScaleTrains.com, Inc. (ScaleTrains) warrants products purchased from our website to be free from defects in material and workmanship for a period of two (2) years from the date of purchase. Products purchased directly from ScaleTrains are automatically registered and a receipt is not required for proof of purchase.

ScaleTrains warrants products purchased from an authorized Select Retailer to be free from defects in material and workmanship for a period of one (1) year from the date of purchase. The warranty period can be extended to two (2) years by registering the product within 30 days of purchase on our website at www.ScaleTrains.com/warranty. Be sure to retain the receipt as proof of purchase as it may be required in the event your model requires warranty service by our Service Center.

If the product fails during the limited warranty period, carefully pack the model in the original packaging. Be sure to include an explanation of the issue(s) along with your name, address, phone and email. If the product(s) were purchased from a Select Retailer, include a legible copy of the sales receipt.

Ship item(s) for repair to our Service Center at...

ScaleTrains Service Center
4901 Old Tasso Road NE
Cleveland, TN 37312

We recommend using a trackable shipping service. Shipping damage incurred on the way to our service center and costs associated with shipping are not covered under warranty.

Damages due to improperly storing, handling, or packaging are not covered under warranty.

If ScaleTrains.com deems the product to be defective, we will either (1) repair (2) replace the item, or (3) offer a store credit redeemable at ScaleTrains.com toward a future purchase. This determination is at the sole discretion of ScaleTrains.

ScaleTrains has the final decision on all warranty matters. The warranty policy is subject to change without notice.