



OPERATOR HO SCALE TRINITY 31K TANK CAR

Operator™ trains are built for modelers who enjoy running high-quality, realistic trains at an affordable price. Designed from builder's drawings and photographs, Operator models have fewer factory-applied parts and simplified printing. For added versatility, super-detail parts are available separately.

Since 2012, **TrinityRail®** has built thousands of 31K Gallon Tank Cars with head shields to meet the growing demands of the oil industry. This tank car is easily recognized by its unique trapezoid-shaped end shields. Mile-long unit trains

with 100+ cars crisscross the United States and Canada daily to deliver crude from the oil fields of North Dakota, Wyoming and Montana to refineries on the East, Gulf and West Coasts. As demand for shipping crude oil by rail has declined, these cars are now carrying ethanol, gasoline, petroleum distillates, and other commodities. In addition, these cars can often be found in mixed freight trains.

PROTOTYPE SPECIFIC SCALETRAINS

- **Molded plastic head shields with integrated hazmat placard holders**
- **12 different road numbers per roadname**
- **24 additional Rivet Counter™ series road numbers available per roadname**
- **Highly detailed one-piece injection-molded tank body with individual end caps**
- **Molded plastic end frames with integrated hazmat placard holders**
- **Finely molded manway cover and protective housing**
- **Finely molded plastic top and end platforms**
- **Standard full-height ladders**
- **Simplified underbody brake rigging**
- **Highly detailed, one-piece ASF Motion Control Super Service 110-ton trucks**
- **36" machined metal wheels**
- **Starter dimples for modeler-applied grab irons, uncoupling levers, and train line hoses available separately**
- **Detail upgrade kit - metal side sill and end drop grab irons, coupler cut levers, train line hoses, and long brake rod. Sold separately**
- **Decal upgrade sheet - includes hazmat "1267" placards, Chemtrec labels, FRA-224 yellow conspicuity stripes, and end head shield printing. Sold separately**
- **Minimum radius: 18"**
- **Recommended radius: 22"**
- **Factory assembled**
- **Color matched to Tru-Color paint colors**
- **Printing and lettering legible under magnification**
- **Simplified underbody brake rigging**
- **Body mounted semi-scale knuckle couplers**
- **Accurately profiled .110" wide wheel tread**
- **Weighted to Industry standards**
- **Operates on Code 70, 83 and 100 rail**
- **Packaging safely stores model**

ScaleTrains • 4901 Old Tasso Rd NE, Cleveland, TN 37312 • www.ScaleTrains.com
Toll-Free 844-9TRAINS • International 423-299-3689

WARNING: This product may contain a chemical known to the State of California to cause cancer or birth defects or other reproductive harm.
© 2023 ScaleTrains.com, Inc., ScaleTrains, Rivet Counter and respective logos and slogans are trademarks of ScaleTrains.com, Inc.

Top Detail Set

SXT80193

Set Includes

- Manway Bonnet Housing and Base
- Manway Cover
- Top Platform Railing - Short
- Top Platform Railing - Long
- Top Platform Walkway (2)

Full Ladder / Anti-Personnel Rod Set

SXT80195

Set Includes

- Anti-Personnel Rod "B" - Left
- Anti-Personnel Rod "B" - Right
- Anti-Personnel Rod "A" - Left
- Anti-Personnel Rod "A" - Right
- Side Ladder - Left
- Side Ladder - Right
- Side Ladder Support (4)

Underbody Detail Set

SXT80194

Set Includes

- Brake Linkage Assembly
- Bottom Skid Plate
- Outlet Pipe
- Outlet Valve Handle
- Main Airline
- Main Airline Support Bracket (4)

Head Shields and Details

SXT80197

Set Includes

- Head Shield B End
- Head Shield A End
- Brakewheel
- Handbrake Housing and Chain

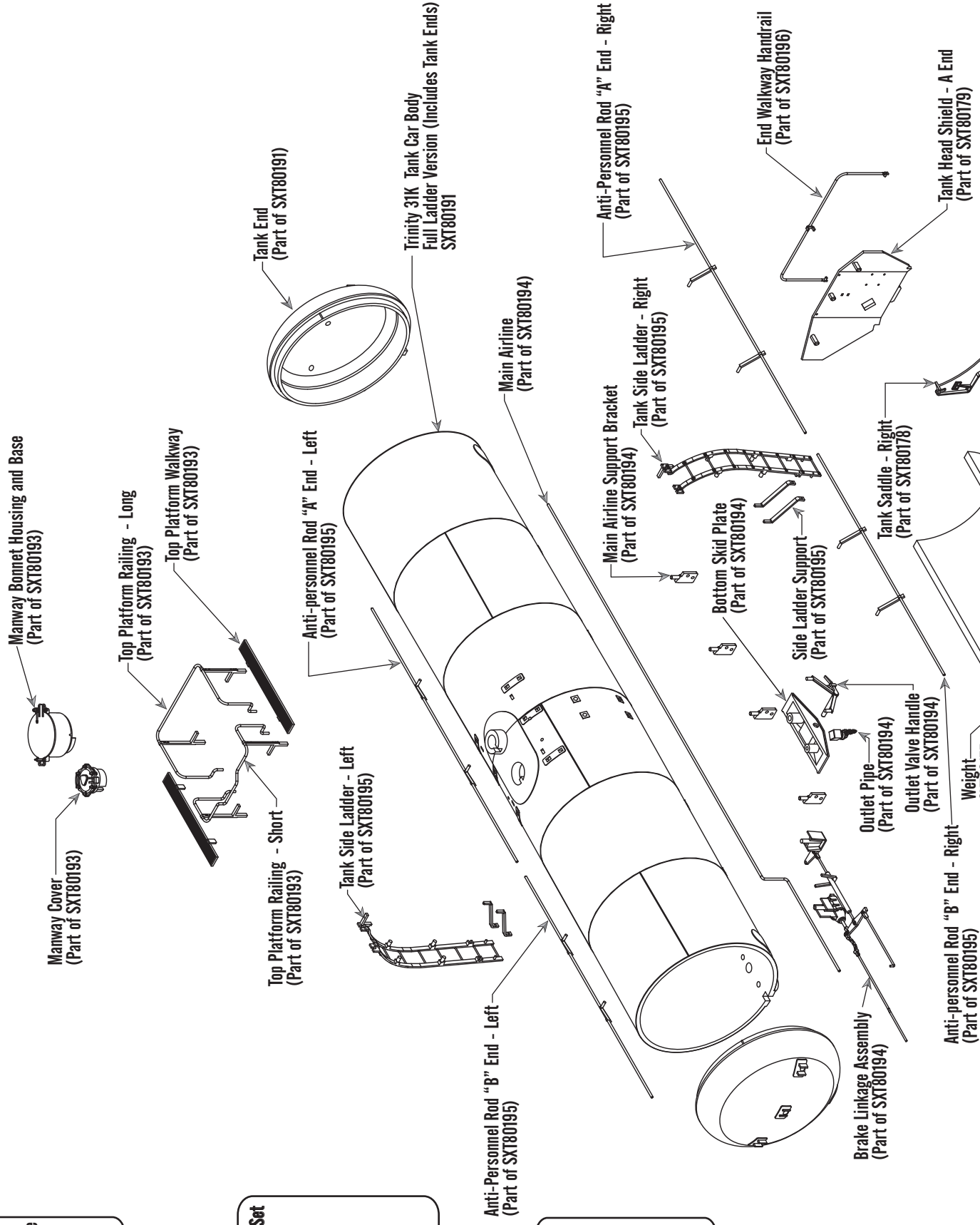

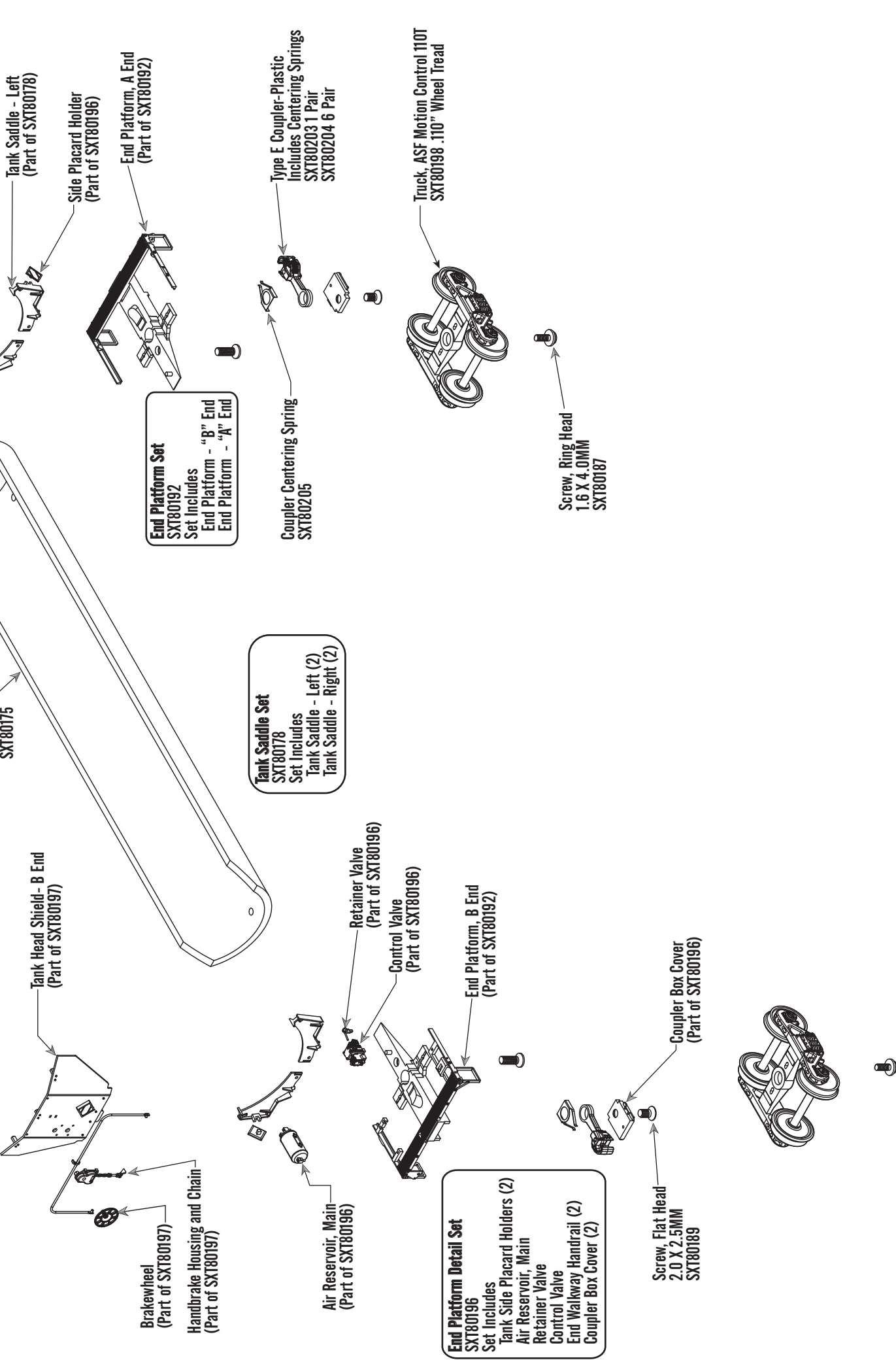

OPERATOR HO SCALE TRINITY 31K TANK CAR PARTS LIST

SXT80190 Instruction Sheet
SXT80191 Body Assembly, Full Ladder
SXT80192 End Platform Set
SXT80178 Saddle Set
SXT80193 Top Detail Set
SXT80194 Underbody Detail Set
SXT80195 Full Ladder / Anti-Personnel Rod Set
SXT80196 End Platform Detail Set
SXT80197 Head Shileds and Details

SXT80198 Truck Assembly, ASF Motion Control 110 Ton .110" Wheel Tread
SXT80189 Coupler Screw, Flat Head, For Plastic, 2.0 X 2.5MM
SXT80168 Type E Coupler, Plastic 2 Pair
SXT80169 Type E Coupler, Plastic 6 Pair
SXT80205 Coupler Centering Spring
SXT80206 Coupler Knuckle Spring
SXT80187 Truck Screw, Ring Head, For Plastic, 1.6 X 4.0MM
SXT80188 End Platform Screw, Flat Head, For Plastic, 2.0 X 6.0MM
SXT80189 Coupler Screw, Flat Head, For Plastic, 2.0 X 2.5MM

For a list of parts included in each parts set, see the exploded view.

ADDITIONAL PARTS AVAILABLE

SXT80222 Detail Upgrade Kit - Set includes: Four Side Sill Drop Grabirons, Four End Drop Sill Grabirons, Two Trainline Hoses and One Brake Rod Long.

Decal Upgrade Sheet

Decal upgrade sheets include hazmat "1267" placards, Chemtrec labels, FRA-224 yellow conspicuity stripes, and end Head Shield printing

SXT80223 DPRX - Deep Rock Refining Co.
SXT80224 TILX Black - Trinity Industries Leasing Co.
SXT80225 GATX - General American Transportation Co.
SXT80226 VMSX - Valero Marketing & Supply Co.
SXT80227 TILX Black / White - Trinity Industries Leasing Co.
SXT80228 SCMX - Shell Oil Co.



PRODUCT SUPPORT

U.S. 844-9TRAINS; 844-987-2467 Ext. 2
International 423-299-3689
Support@ScaleTrains.com



ScaleTrains

4901 Old Tasso Rd NE,
Cleveland, TN 37312 USA



www.ScaleTrains.com

SIGNUP FOR OUR WEEKLY NEWSLETTER

www.ScaleTrains.com/newsletter



FOLLOW SCALETRAINS



WARRANTY POLICY

ScaleTrains.com, Inc. (ScaleTrains) warrants products purchased from our website to be free from defects in material and workmanship for a period of two (2) years from the date of purchase. Products purchased directly from ScaleTrains are automatically registered and a receipt is not required for proof of purchase.

ScaleTrains warrants products purchased from an authorized Select Retailer to be free from defects in material and workmanship for a period of one (1) year from the date of purchase. The warranty period can be extended to two (2) years by registering the product within 30 days of purchase on our website at www.ScaleTrains.com/warranty. Be sure to retain the receipt as proof of purchase as it may be required in the event your model requires warranty service by our Service Center.

If the product fails during the limited warranty period, carefully pack the model in the original packaging. Be sure to include an explanation of the issue(s) along with your name, address, phone and email. If the product(s) were purchased from a Select Retailer, include a legible copy of the sales receipt.

Ship item(s) for repair to our Service Center at...

ScaleTrains Service Center
4901 Old Tasso Road NE
Cleveland, TN 37312

We recommend using a trackable shipping service. Shipping damage incurred on the way to our service center and costs associated with shipping are not covered under warranty.

Damages due to improperly storing, handling, or packaging are not covered under warranty.

If ScaleTrains.com deems the product to be defective, we will either (1) repair (2) replace the item, or (3) offer a store credit redeemable at ScaleTrains.com toward a future purchase. This determination is at the sole discretion of ScaleTrains.

ScaleTrains has the final decision on all warranty matters. The warranty policy is subject to change without notice.