



RIVET COUNTER HO SCALE UP EARLY STEAM EXCURSION WATER TENDER SET

Our **Rivet Counter™** brand strives to create the most accurately detailed model trains imaginable. The real-world counterpart is meticulously researched to ensure prototype fidelity. Each model features numerous factory applied parts including **railroad, road number, and era-specific™** details whenever possible.

After the Union Pacific GTEL 8,500 Horsepower "Big Blow" Super Turbines were retired in the late 1960s, the 23-C-GTE and 24-C-GTE fuel tenders were repurposed for various duties around the UP system, including water or fuel oil

storage, and for derrick outfits. Only a few survived, such as tender 24-GTE-14 and 24-GTE-16, which were later renumbered as 907857 and 907856, respectively.

They were first used in derrick service, then repurposed as fuel/water storage tanks at UP facilities in Los Angeles. In the 1980s, they were assigned to the UP steam program, with some necessary modifications to water connections and plumbing. They were renumbered as UPP 814 and UPP 809 in 2003, indicating their use with the steam program.

ROADNAME AND ROAD NUMBER SPECIFIC SCALE TRAINS

- All new model
- Both version have different plumbing detail
- Roof equipment boxes and water plumbing details
- Commonwealth 3-axle trucks
- 24,000-gallon capacity
- Intricate electrical and water plumbing
- Brake beam
- Handbrake housing with finely detailed wheel and chain
- Underbody brake details and plumbing
- Durable body-mounted metal semi-scale Type E knuckle couplers
- 36" Machined metal wheels
- Directional lighting
- Truck chains available separately - requires 22" radius curve
- Minimum radius 18"
- Fully assembled
- Color matched to Tru-Color paint colors
- Printing and lettering legible under magnification
- Accurately profiled .110" wide wheel tread
- Coupler cut levers
- Trainline hoses
- Intricate brake plumbing
- Weighted to Industry standards
- Operates on Code 70, 83 and 100 rail
- Packaging safely stores model

ScaleTrains • 4901 Old Tasso Rd NE, Cleveland, TN 37312 • www.ScaleTrains.com
Toll-Free 844-9TRAINS • International 423-299-3689

WARNING: This product may contain a chemical known to the State of California to cause cancer or birth defects or other reproductive harm.
© 2023 ScaleTrains.com, Inc., ScaleTrains, Rivet Counter and respective logos and slogans are trademarks of ScaleTrains.com, Inc.



Body Assembly -UPP 907856
SXT80132
Set Includes
Body, UPP 907856
Body End Cover, Front UPP 907856
Body End Cover, Rear UPP 907856
Tender Bottom Cover (2)

Body Assembly -UPP 907857
SXT80297
Set Includes
Body, UPP 907857
Body End Cover, Front UPP 907857
Body End Cover, Rear UPP 907857
Tender Bottom Cover (2)

Body Parts Not Shown For UPP 907856
Are Part Of SXT80134

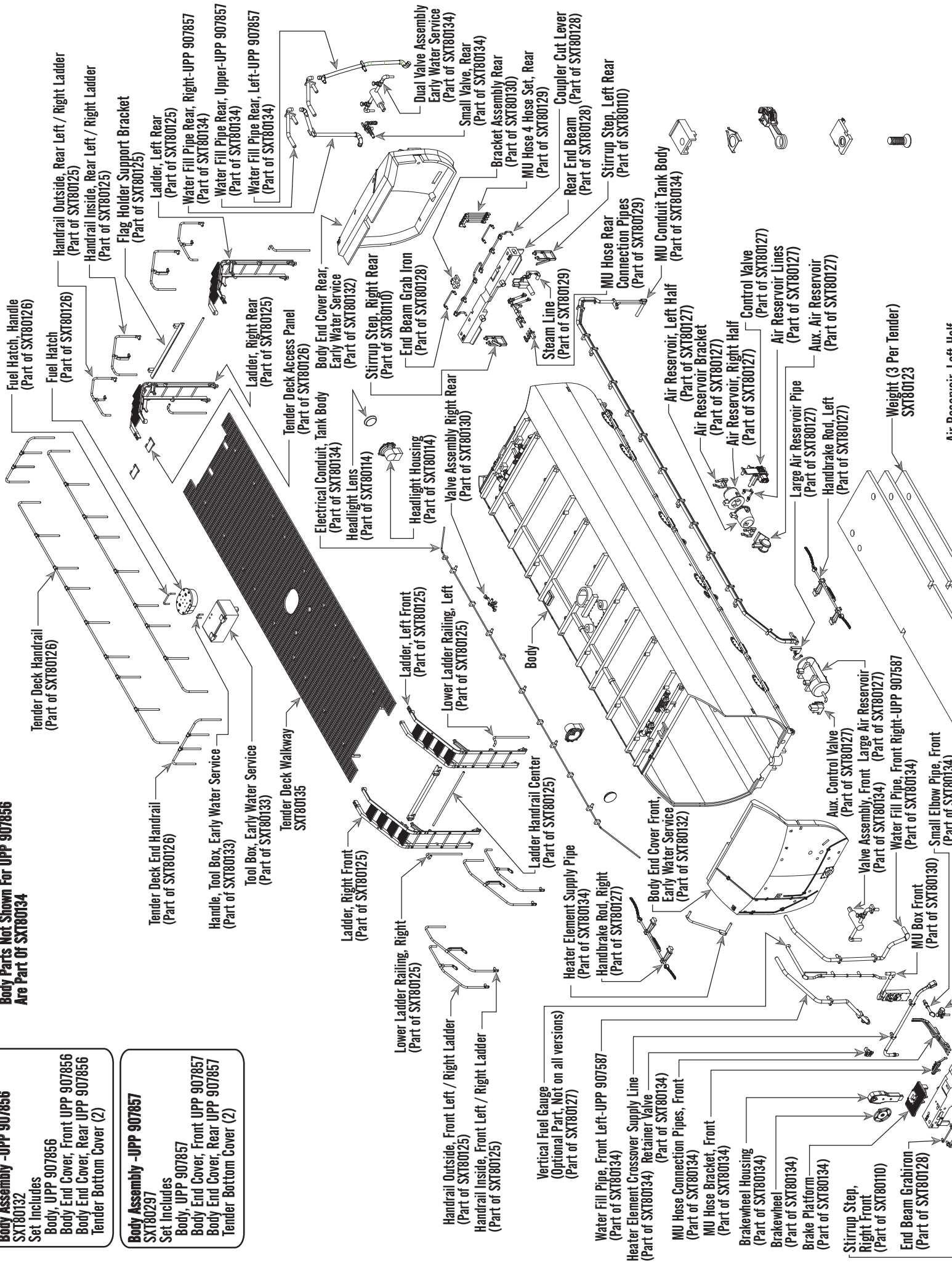

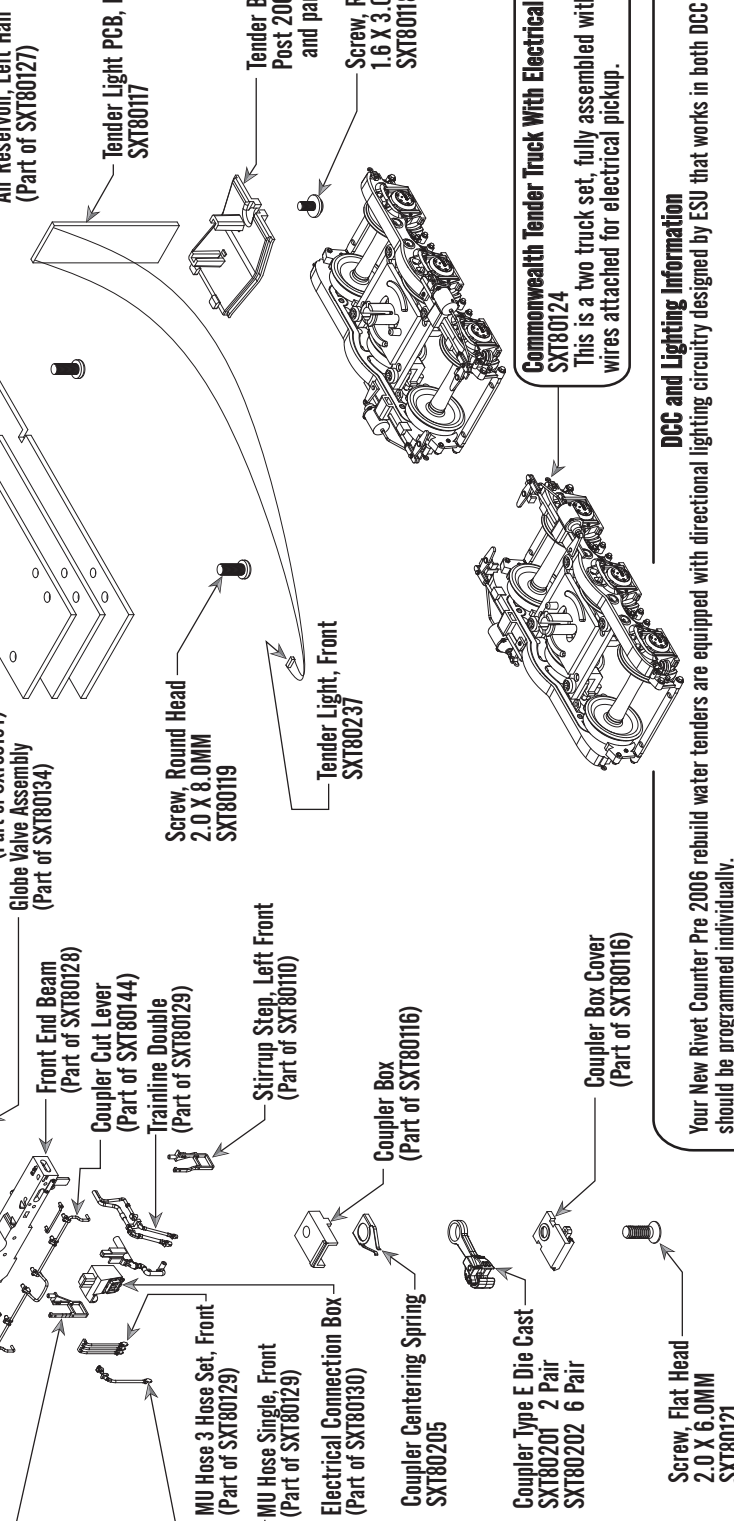

Truck Safety Chain Detail UPGRADE KIT
 SXT80111
 Set Includes
 Truck Safety Chain (8)
 Safety Chain Eyelet (8)

Commonwealth Tender Truck With Electrical Pick Up
 SXT80124
 This is a two truck set, fully assembled with wires attached for electrical pickup.

DCC and Lighting Information

Your New Rivet Counter Pre 2006 rebuild water tenders are equipped with directional lighting circuitry designed by ESU that works in both DCC and DC. It is a two (2) function decoder and each tender should be programmed individually.
 From the factory, the default address is 03.
 Two (2) or four (4) digit addresses can be programmed on all DCC systems.
 The decoder supports CV 1 addressing short address 1-127
 The decoder also supports CV 17/18 long address 128-9999 - Please add 32 to value of CV 29 to enter long addresses.
 NMRA consisting is supported using CV's 19, 21 and 22.
 To reset the decoder, change the value of CV 8 to eight (8) on a programming track. Do not reset the decoder on the main because a power recycle is required.

Short address CV 1 -03
 Manufacturer CV 8 -151
 Long (Extended) address CV 17/CV 18 -192/128
 CV 29 contains important information for setting up your decoder.
 Default value is 4 with a range of 0-255
 Please add or subtract the value of each bit from the value of CV 29 to make changes.
 Examples: If you wish to reverse the direction(forward becomes reverse), add one(1) from the value read from CV 29.
 If you wish to disable analog mode subtract four (4) from the value of read from CV 29. It is best to read the value of 29 first as your DCC system may change this without your knowledge. Especially when changing to a 4 digit address.

Function Chart

Reverse direction of travel (forward becomes reverse)
 Speed steps: 0 = 14 speed steps, 2 = 28 / 128 speed steps
 Analog mode enable, 4 = Analog mode enabled
 Speed curve selection. 0 = CV 2,5,6 ; 16 = CV 67 - 94
 Address select. 0 = Primary address, 32 = Extended address

Headlight CVs

There may be times that wish to function map your headlights for your operating needs.

CV 33(Front Light) Value of 1 (on in forward) / Value of 0 (off in forward)
 CV 34(Rear Light) Value of 2 (on in reverse) / Value of 0 (off in reverse)
 Common Changes:
 Front and rear headlights off in both directions - CV 33=0, CV 34=0
 Front headlight off in both directions - CV 33=0, CV 34=1
 To control the rear headlight of the rear tender using F10 - CV 44 = 2

Bit	Value
0	1
1	2
2	4
4	16
5	32

Please see our web page
www.scaletrains.com
 for additional information.

RIVET COUNTER HO SCALE UP EARLY STEAM EXCURSION WATER TENDER SET PARTS LIST

SXT80131 Instruction Sheet - Download for FREE from our Website
SXT80132 Body Assembly - UPP 907856
SXT80297 Body Assembly - UPP 907857
SXT80123 Tender Weight
SXT80124 Commonwealth Tender Truck with Electrical Pickup
SXT80105 Tender Truck Wheelset for standard bearing
SXT80125 Tender Ladder Set
SXT80133 Tender Deck Detail Set
SXT80127 Tender Underbody Detail Set
SXT80128 End Beam Set
SXT80110 Stirrup Step Set
SXT80129 Multiple Unit / Trainline Hose Set
SXT80134 Tender Body Detail Set

SXT80114 Headlight Assembly
SXT80128 End Beam Detail Set
SXT80117 Tender Light Circuit Board
SXT80118 Tender Bottom Cover Screw, Ringed Head, 1.6MM X 3.0MM
SXT80119 Weight Screw, Round Head, 2.0MM X 5.0MM
SXT80120 Truck Bolster Screw, Round Head, 1.6MM X 3.0MM
SXT80121 Coupler Screw, Flat Head, 2.0MM X 6.0MM
SXT80201 Type E Coupler, Die-Cast 2 Pair
SXT80202 Type E Coupler, Die-Cast 6 Pair
SXT80205 Coupler Centering Spring
SXT80206 Coupler Knuckle Spring

For a list of parts included in each parts set, see the exploded view.

ADDITIONAL PARTS AVAILABLE

SXT80111 Tender Truck Safety Chain Set

The installation of the truck safety chains requires modeling skills. In addition, the use of truck safety chains increases the minimum radius to 22 inches.



PRODUCT SUPPORT

U.S. 844-9TRAINS; 844-987-2467 Ext. 2
International 423-299-3689
Support@ScaleTrains.com



ScaleTrains

4901 Old Tasso Rd NE,
Cleveland, TN 37312 USA



www.ScaleTrains.com

SIGNUP FOR OUR WEEKLY NEWSLETTER

www.ScaleTrains.com/newsletter



FOLLOW SCALETRAINS



WARRANTY POLICY

ScaleTrains.com, Inc. (ScaleTrains) warrants products purchased from our website to be free from defects in material and workmanship for a period of two (2) years from the date of purchase. Products purchased directly from ScaleTrains are automatically registered and a receipt is not required for proof of purchase.

ScaleTrains warrants products purchased from an authorized Select Retailer to be free from defects in material and workmanship for a period of one (1) year from the date of purchase. The warranty period can be extended to two (2) years by registering the product within 30 days of purchase on our website at www.ScaleTrains.com/warranty. Be sure to retain the receipt as proof of purchase as it may be required in the event your model requires warranty service by our Service Center.

If the product fails during the limited warranty period, carefully pack the model in the original packaging. Be sure to include an explanation of the issue(s) along with your name, address, phone and email. If the product(s) were purchased from a Select Retailer, include a legible copy of the sales receipt.

Ship item(s) for repair to our Service Center at...

ScaleTrains Service Center
4901 Old Tasso Road NE
Cleveland, TN 37312

We recommend using a trackable shipping service. Shipping damage incurred on the way to our service center and costs associated with shipping are not covered under warranty.

Damages due to improperly storing, handling, or packaging are not covered under warranty.

If ScaleTrains.com deems the product to be defective, we will either (1) repair (2) replace the item, or (3) offer a store credit redeemable at ScaleTrains.com toward a future purchase. This determination is at the sole discretion of ScaleTrains.

ScaleTrains has the final decision on all warranty matters. The warranty policy is subject to change without notice.